

DESCRIPTION	Usage	No.	Length	Mat.	Qty
Washer40x40x5	HOLDDOWN	N/A		5	4
C9075ra	STUD	N/A	2741	0.75	8
U904475G550	TOPPLATE	N/A	6252	0.75	2
U904475G550	HEAD	N/A	4189	0.75	1
C9075ra	WEB	N/A	606	0.75	6
C9075ra	WEB	N/A	788	0.75	7
U904475G550	NOGGING	N/A	1103	0.75	2
BRA-1.0x25-250	Brace	N/A	2940	1.0	4
TENSIONER_SET	Tensnr	N/A	0	N/A	4
SCREW-M6-1PX18-TEK	SCREW	N/A	-	-	24
WALLTITE	SCREW	N/A	-	-	108

Length crib: 2
Floor RL: 0
INTERNAL wall

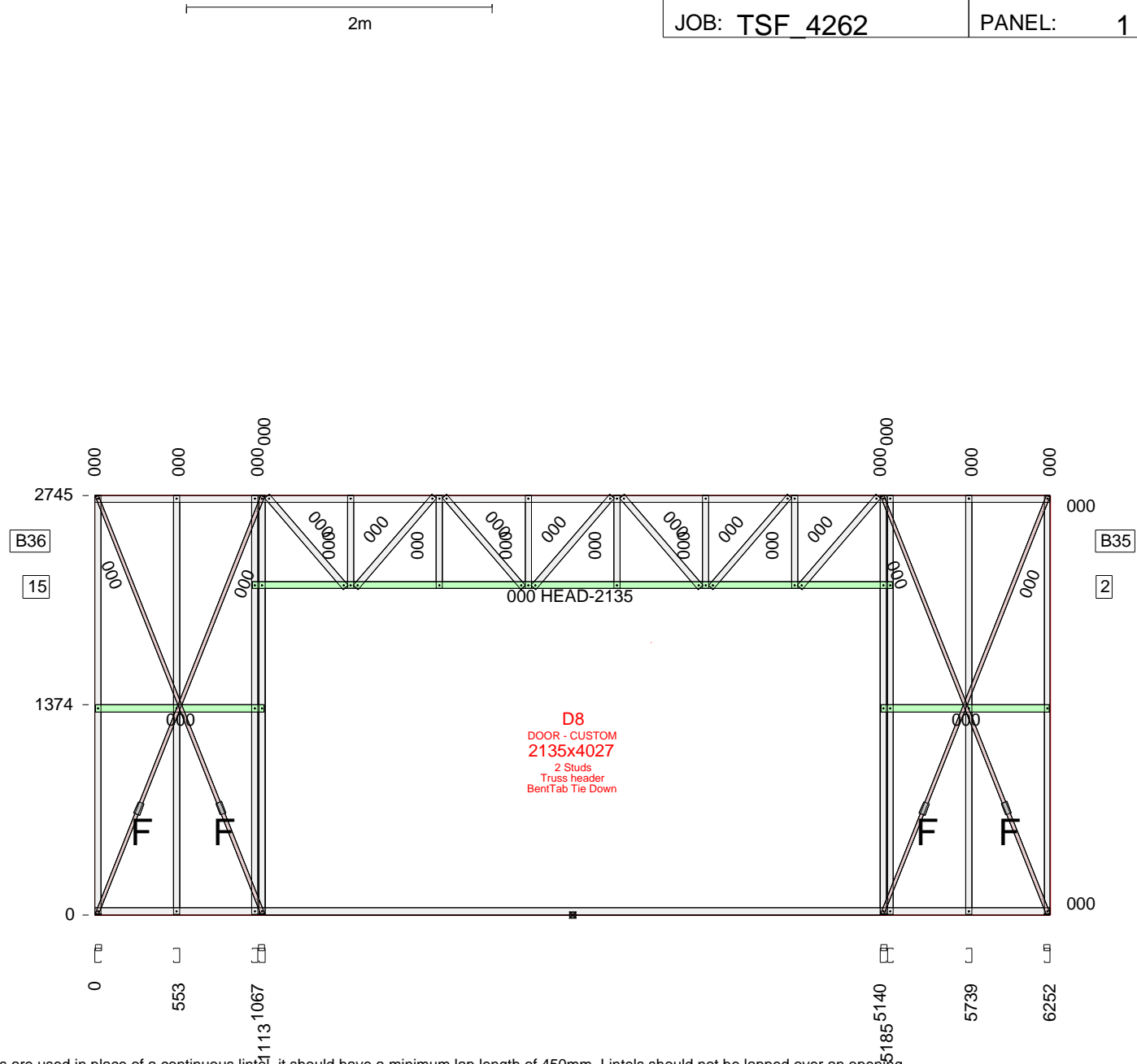

Screws at each end of BRA-1.0x25-250 = 3

All dimensions to back of section. Where multiple lintels are used in place of a continuous lintel, it should have a minimum lap length of 450mm. Lintels should not be lapped over an opening.

ASSEMBLY DETAILS	OPENING DIMENSIONS (steel to steel)				PACKING DETAILS		LENGTH	MAX. HEIGHT
	ID	MANUF.	CAT NO.	UNIT DIM.	LEFT SIDE	RIGHT SIDE	6252	2745
ASSEMBLED: FABRICATOR: TRUE STEEL FRAMES CUSTOMER: BERT FARINA CONSTRUCTIONS CLIENT REF: DW2 14 BAKER AVE MORPHETTVILLE	D8	CUSTOM	Custom	2100x3967			DETAILER	DETAILED
							Jarrood	16-07-2019
							WEIGHT	SCALE
							57	1:40

DESCRIPTION	Usage	No.	Length	Mat.	Qty
MULTIGRIP	TIEDOWN	N/A		3	2
Washer40x40x5	HOLDDOWN	N/A		5	3
C9075ra	STUD	N/A	2741	0.75	5
C9075ra	STUD	N/A	2591	0.75	3
C9075ra	STUD	N/A	2637	0.75	2
C9075ra	STUD	N/A	512	0.75	3
C9075ra	STUD	N/A	1471	0.75	3
U904475G550	BOTPLATE	N/A	3398	0.75	1
U904475G550	TOPPLATE	N/A	3249	0.75	1
U904475G550	HEAD	N/A	2022	0.75	3
C10015	HEADER	N/A	1948	1.5	1
U904475G550	SILL	N/A	179	0.75	1
U904475G550	NOGGING	N/A	3388	0.75	1
BRA-1.0x25-250	Brace	N/A	2847	1.0	2
TENSIONER_SET	Tensnr	N/A	0	N/A	2
SCREW-12-14x20-HEX	SCREW	N/A	-	-	8
SCREW-M6-1PX18-TEK	SCREW	N/A	-	-	16
WALLTITE	SCREW	N/A	-	-	112

Length crib: 2
Floor RL: 0
EXTERNAL wall

Screws at each end of BRA-1.0x25-250 = 3

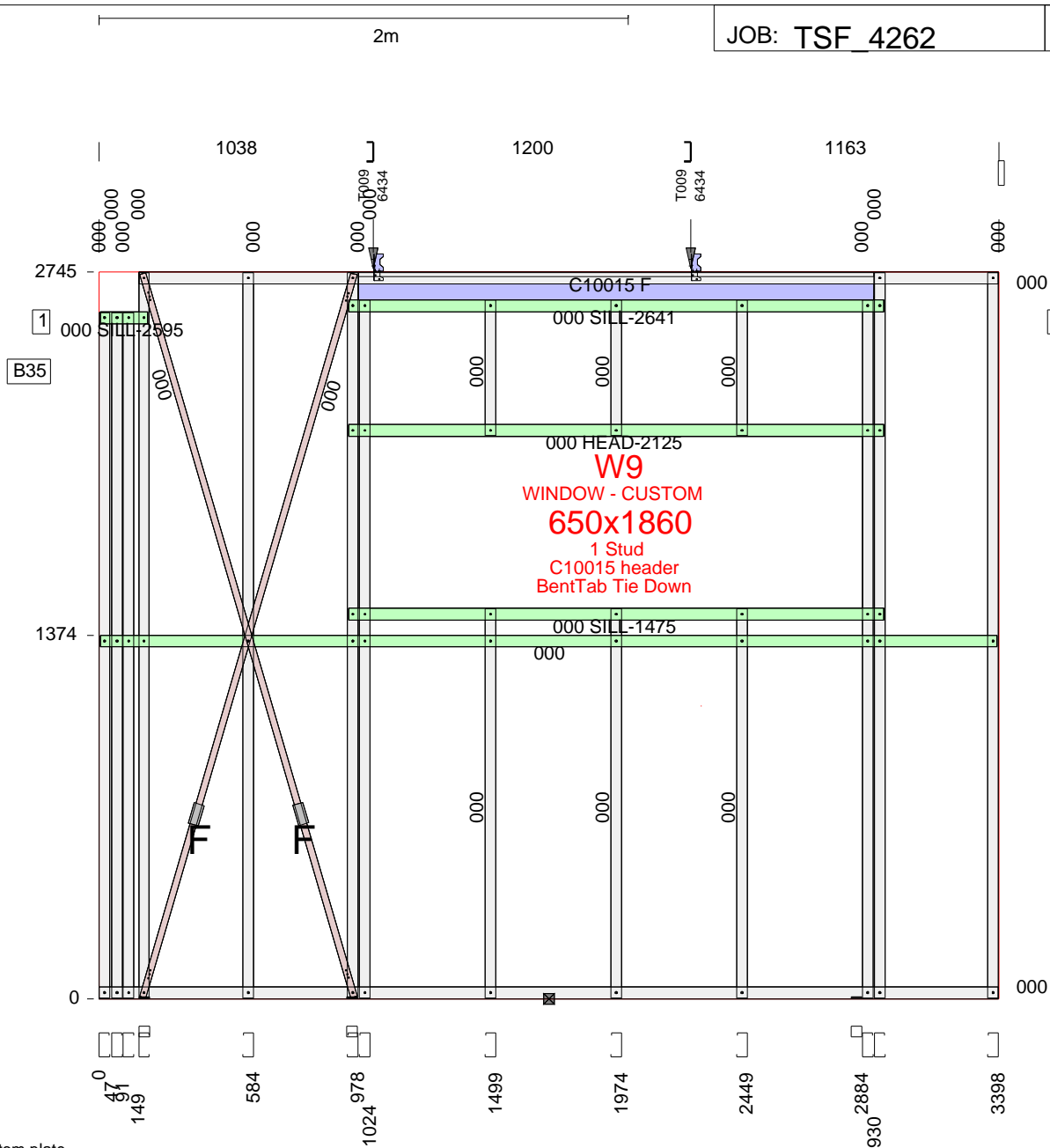

Add membrane to underside and external flange of bottom plate.
All dimensions to back of section. Where multiple lintels are used in place of a continuous lintel, it should have a minimum lap length of 450mm. Lintels should not be lapped over an opening.

ASSEMBLY DETAILS	OPENING DIMENSIONS (steel to steel)				PACKING DETAILS		LENGTH	MAX. HEIGHT
	ID	MANUF.	CAT NO.	UNIT DIM.	LEFT SIDE	RIGHT SIDE	3398	2745
ASSEMBLED:	W9	CUSTOM	Custom	600x1810			DETAILER	DETAILED
FABRICATOR: TRUE STEEL FRAMES							Jarrood	16-07-2019
CUSTOMER: BERT FARINA CONSTRUCTIONS							WEIGHT	SCALE
CLIENT REF: DW2 14 BAKER AVE MORPHETTVILLE							59	1:25

DESCRIPTION	Usage	No.	Length	Mat.	Qty
Washer40x40x5	HOLDDOWN	N/A		5	5
Multigrip	TIEDOWN	N/A		3	4
C9075ra	STUD	N/A	2741	0.75	10
C9075ra	STUD	N/A	1127	0.75	3
U904475G550	TOPPLATE	N/A	4558	0.75	2
U904475G550	HEAD	N/A	850	0.75	2
C9075ra	WEB	N/A	616	0.75	3
C9075ra	WEB	N/A	698	0.75	2
U904475G550	HEAD	N/A	1330	0.75	2
C9075ra	WEB	N/A	710	0.75	3
U904475G550	NOGGING	N/A	504	0.75	1
U904475G550	NOGGING	N/A	1620	0.75	1
U904475G550	NOGGING	N/A	364	0.75	1
U904475G550	NOGGING	N/A	415	0.75	1
C9075ra	WEB	N/A	1401	0.75	1
C9075ra	WEB	N/A	1398	0.75	1
SCREW-12-14x20-HEX	SCREW	N/A	-	-	16
SCREW-M6-1PX18-TEK	SCREW	N/A	-	-	8
WALLTITE	SCREW	N/A	-	-	132

Length crib: 2
Floor RL: 0
EXTERNAL wall

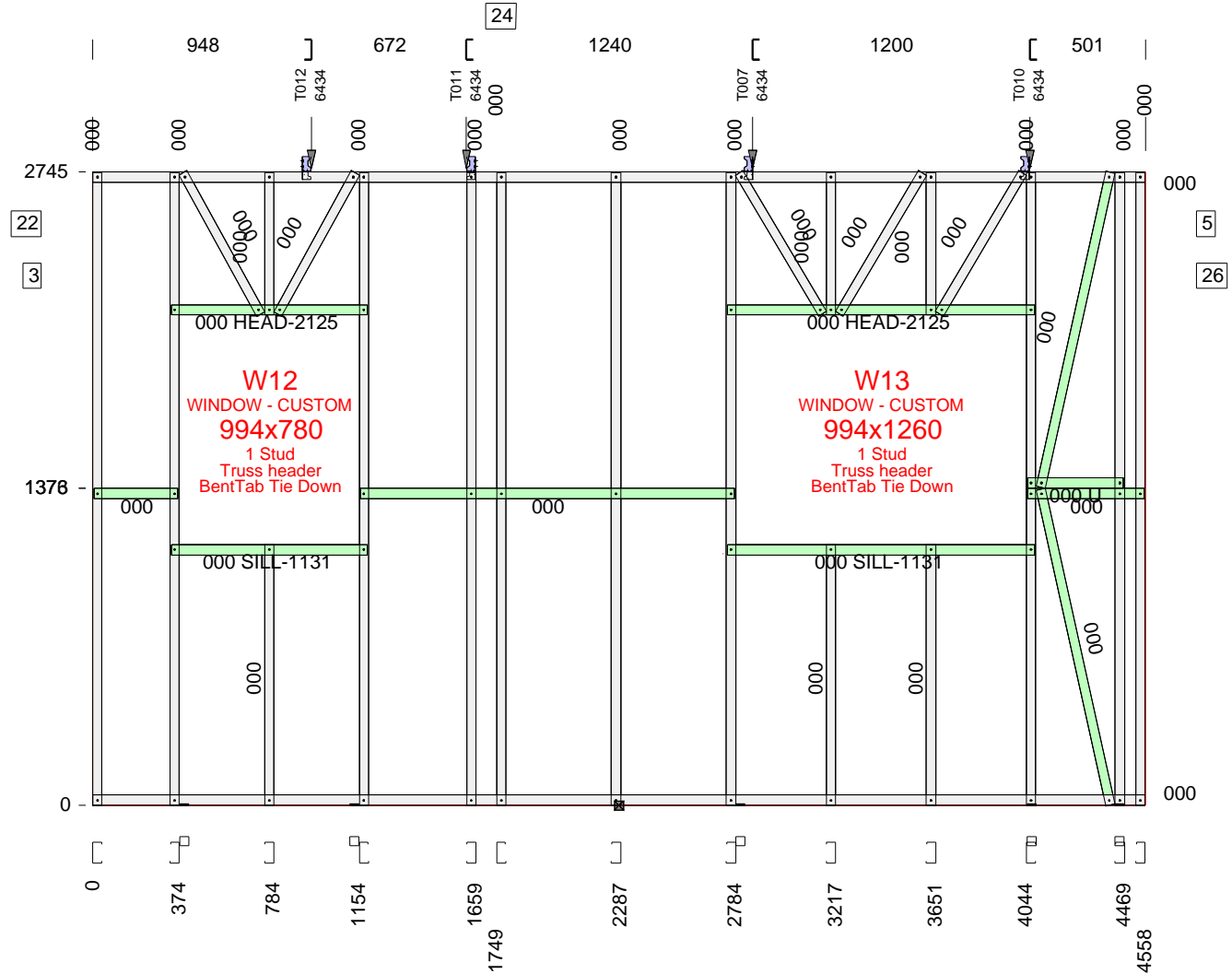

Add membrane to underside and external flange of bottom plate.
All dimensions to back of section. Where multiple lintels are used in place of a continuous lintel, it should have a minimum lap length of 450mm. Lintels should not be lapped over an opening.

ASSEMBLY DETAILS	OPENING DIMENSIONS (steel to steel)				PACKING DETAILS		LENGTH	MAX. HEIGHT
	ID	MANUF.	CAT NO.	UNIT DIM.	LEFT SIDE	RIGHT SIDE	4558	2745
ASSEMBLED: FABRICATOR: TRUE STEEL FRAMES CUSTOMER: BERT FARINA CONSTRUCTIONS CLIENT REF: DW2 14 BAKER AVE MORPHETTVILLE	W12	CUSTOM	Custom	944x730			DETAILER	DETAILED
	W13	CUSTOM	Custom	944x1210			Jarrood	16-07-2019
							WEIGHT	SCALE
							60	1:30

DESCRIPTION	Usage	No.	Length	Mat.	Qty
Washer40x40x5	HOLDDOWN	N/A		5	2
Multigrip	TIEDOWN	N/A		3	3
C9075ra	STUD	N/A	2741	0.75	10
U904475G550	TOPPLATE	N/A	3568	0.75	2
U904475G550	NOGGING	N/A	3558	0.75	1
BRA-1.0x25-250	Brace	N/A	3952	1.0	2
TENSIONER_SET	Tensnr	N/A	0	N/A	2
SCREW-12-14x20-HEX	SCREW	N/A	-	-	12
SCREW-M6-1PX18-TEK	SCREW	N/A	-	-	18
WALLTITE	SCREW	N/A	-	-	60

Length crib: 2
Floor RL: 0
EXTERNAL wall

Screws at each end of BRA-1.0x25-250 = 3

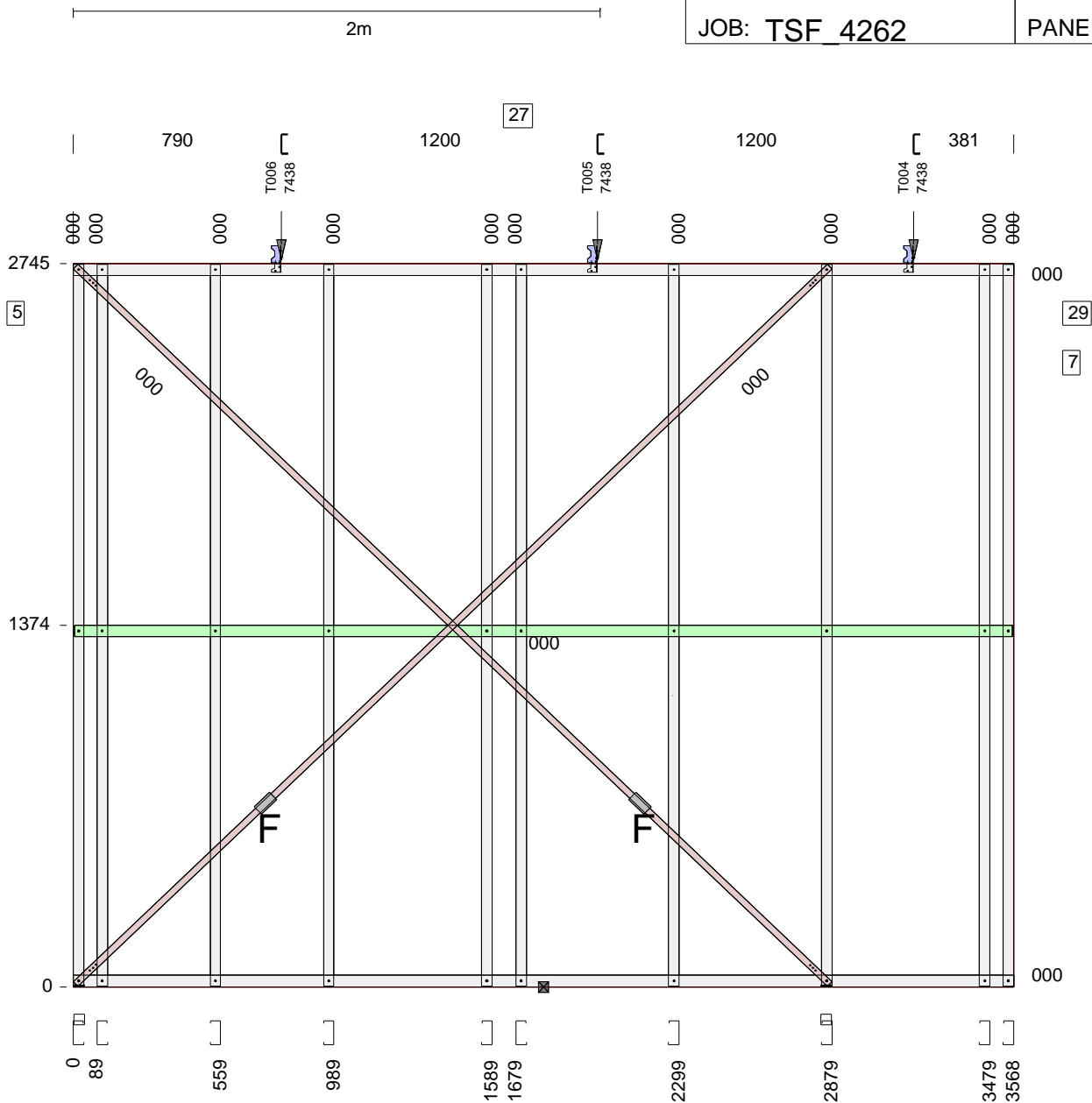

Add membrane to underside and external flange of bottom plate.
All dimensions to back of section. Where multiple lintels are used in place of a continuous lintel, it should have a minimum lap length of 450mm. Lintels should not be lapped over an opening.

ASSEMBLY DETAILS	OPENING DIMENSIONS (steel to steel)					PACKING DETAILS		LENGTH	MAX. HEIGHT
	ID	HEIGHT	WIDTH	HEAD	SILL	LEFT SIDE	RIGHT SIDE	3568	2745
ASSEMBLED:								DETAILER	DETAILED
FABRICATOR: TRUE STEEL FRAMES								Jarrood	16-07-2019
CUSTOMER: BERT FARINA CONSTRUCTIONS								WEIGHT	SCALE
CLIENT REF: DW2 14 BAKER AVE MORPHETTVILLE								43	1:25

DESCRIPTION	Usage	No.	Length	Mat.	Qty
Sheet_steel_0.40mm	PanelBrace	N/A	2741	0.4	1
Washer40x40x5	HOLDDOWN	N/A	-	5	6
C9075ra	STUD	N/A	2741	0.75	6
C9075ra	STUD	N/A	271	0.75	2
U904475G550	TOPPLATE	N/A	3002	0.75	2
U904475G550	HEAD	N/A	850	0.75	4
C9075ra	WEB	N/A	616	0.75	2
C9075ra	WEB	N/A	698	0.75	4
U904475G550	NOGGING	N/A	564	0.75	1
U904475G550	NOGGING	N/A	290	0.75	1
U904475G550	NOGGING	N/A	558	0.75	2
C9075ra	WEB	N/A	1439	0.75	1
C9075ra	WEB	N/A	1435	0.75	1
WALLTITE	SCREW	N/A	-	-	96

Length crib: 2
Floor RL: 0
EXTERNAL wall

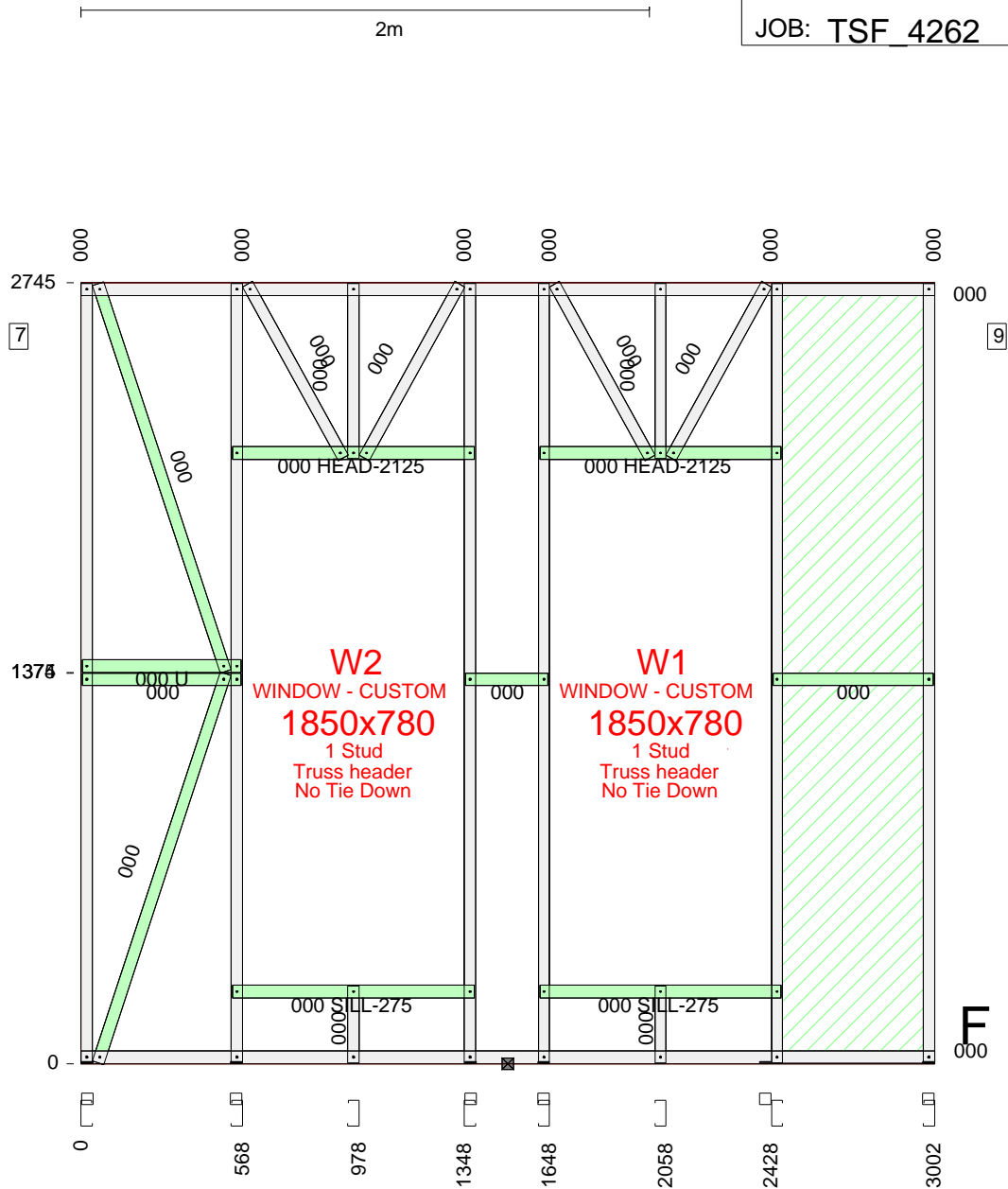

Add membrane to underside and external flange of bottom plate.
All dimensions to back of section. Where multiple lintels are used in place of a continuous lintel, it should have a minimum lap length of 450mm. Lintels should not be lapped over an opening.

ASSEMBLY DETAILS	OPENING DIMENSIONS (steel to steel)				PACKING DETAILS		LENGTH	MAX. HEIGHT
	ID	MANUF.	CAT NO.	UNIT DIM.	LEFT SIDE	RIGHT SIDE	3002	2745
ASSEMBLED:	W1	CUSTOM	Custom	1800x730			DETAILER	DETAILED
FABRICATOR: TRUE STEEL FRAMES	W2	CUSTOM	Custom	1800x730			Jarrood	16-07-2019
CUSTOMER: BERT FARINA CONSTRUCTIONS							WEIGHT	SCALE
CLIENT REF: DW2 14 BAKER AVE MORPHETTVILLE							43	1:25

DESCRIPTION	Usage	No.	Length	Mat.	Qty
MULTIGRIP	TIEDOWN	N/A		3	4
C9075ra	STUD	N/A	2741	0.75	13
C9075ra	STUD	N/A	2591	0.75	1
U904475G550	TOPPLATE	N/A	2889	0.75	1
U904475G550	BOTPLATE	N/A	3938	0.75	1
U904475G550	HEAD	N/A	980	0.75	1
C9075ra	WEB	N/A	631	0.75	1
C9075ra	WEB	N/A	744	0.75	2
U904475G550	SILL	N/A	120	0.75	1
U904475G550	TOPPLATE	N/A	999	0.75	1
U904475G550	NOGGING	N/A	174	0.75	1
U904475G550	NOGGING	N/A	2834	0.75	1
C9075ra	STIFFENER	N/A	391	0.75	2
C9075ra	STIFFENER	N/A	368	0.75	1
SCREW-12-14x20-HEX	SCREW	N/A	-	-	16
SCREW-M6-1PX18-TEK	SCREW	N/A	-	-	8
WALLTITE	SCREW	N/A	-	-	122

Length crib: 2
Floor RL: 0
INTERNAL wall

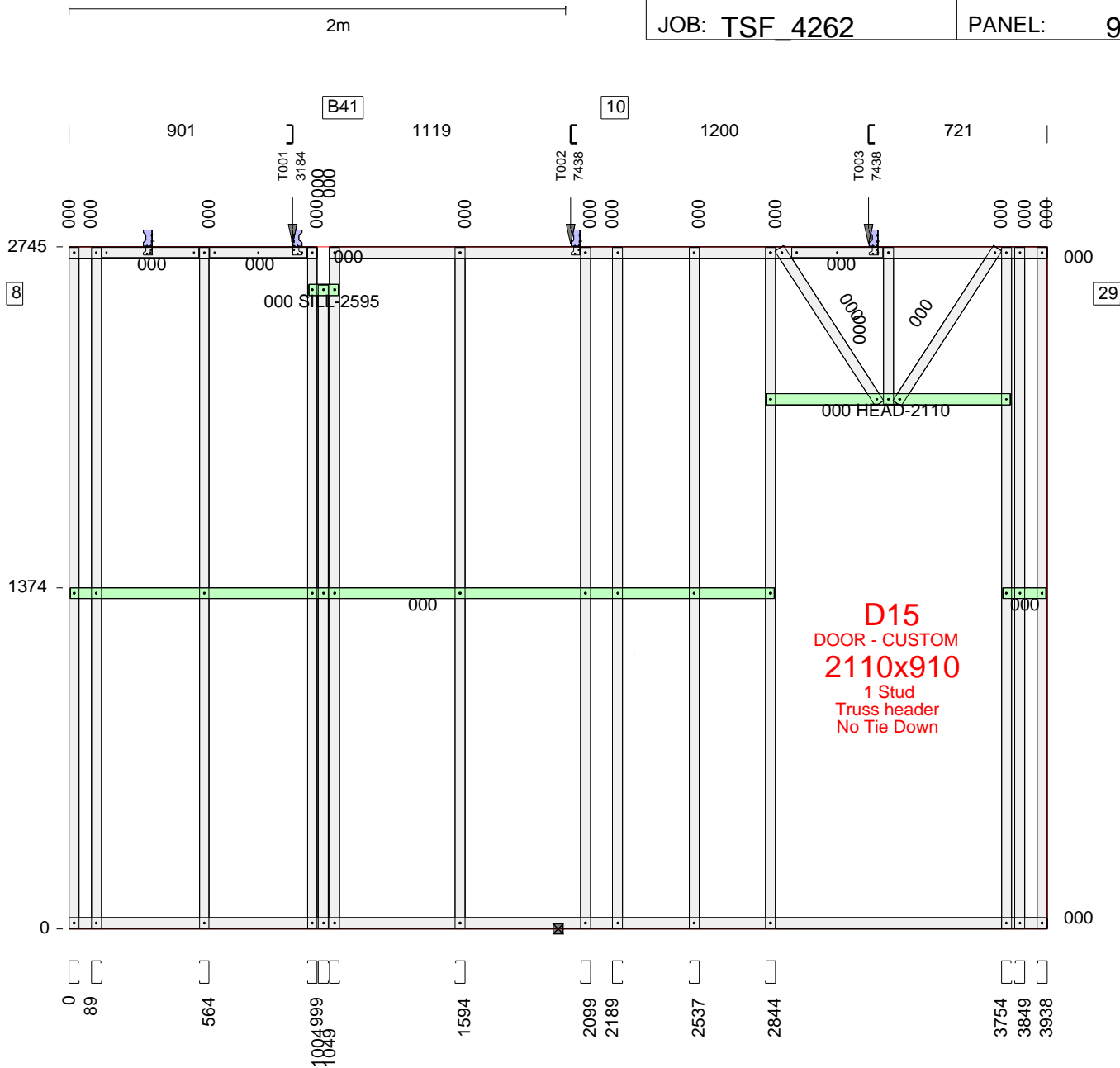

All dimensions to back of section. Where multiple lintels are used in place of a continuous lintel, it should have a minimum lap length of 450mm. Lintels should not be lapped over an opening.

ASSEMBLY DETAILS	OPENING DIMENSIONS (steel to steel)				PACKING DETAILS		LENGTH	MAX. HEIGHT
	ID	MANUF.	CAT NO.	UNIT DIM.	LEFT SIDE	RIGHT SIDE	3938	2745
ASSEMBLED:	D15	CUSTOM	Custom	2040x820			DETAILER	DETAILED
FABRICATOR: TRUE STEEL FRAMES							Jarrood	16-07-2019
CUSTOMER: BERT FARINA CONSTRUCTIONS							WEIGHT	SCALE
CLIENT REF: DW2 14 BAKER AVE MORPHETTVILLE							58	1:25

DESCRIPTION	Usage	No.	Length	Mat.	Qty
Washer40x40x5	HOLDDOWN	N/A		5	2
C9075ra	STUD	N/A	2741	0.75	7
U904475G550	TOPPLATE	N/A	1288	0.75	2
U904475G550	HEAD	N/A	1072	0.75	1
C9075ra	WEB	N/A	615	0.75	1
C9075ra	WEB	N/A	731	0.75	2
U904475G550	NOGGING	N/A	134	0.75	1
U904475G550	NOGGING	N/A	224	0.75	1
WALLTITE	SCREW	N/A	-	-	62

Length crib: 2
Floor RL: 0
INTERNAL wall

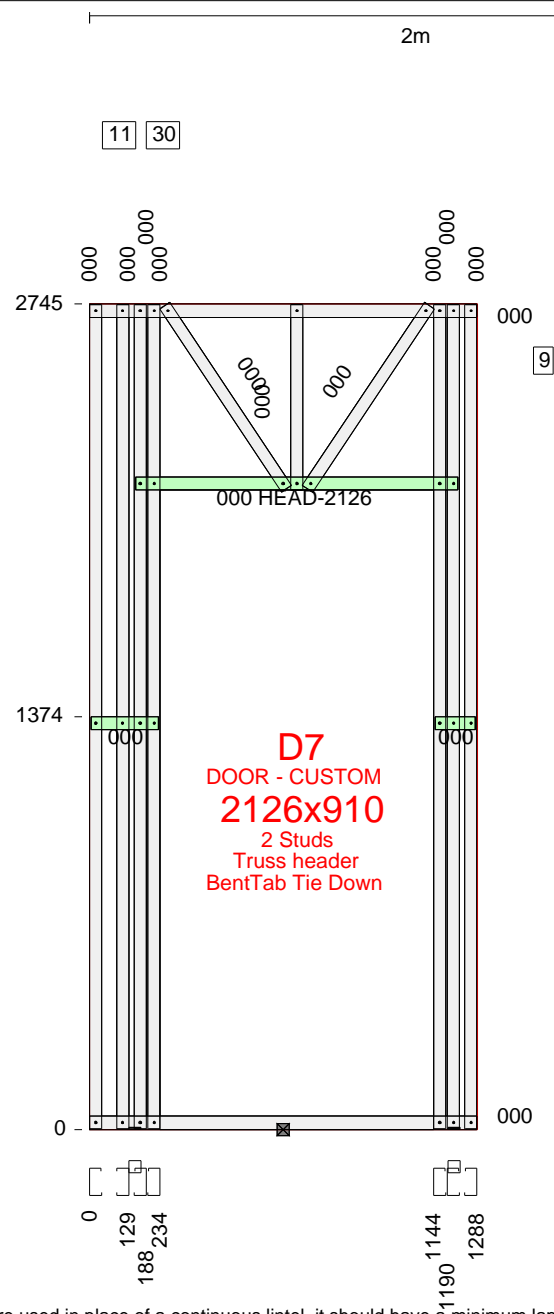

All dimensions to back of section. Where multiple lintels are used in place of a continuous lintel, it should have a minimum lap length of 450mm. Lintels should not be lapped over an opening.

ASSEMBLY DETAILS		OPENING DIMENSIONS (steel to steel)				PACKING DETAILS		LENGTH	MAX. HEIGHT
		ID	MANUF.	CAT NO.	UNIT DIM.	LEFT SIDE	RIGHT SIDE	1288	2745
ASSEMBLED: FABRICATOR: TRUE STEEL FRAMES CUSTOMER: BERT FARINA CONSTRUCTIONS CLIENT REF: DW2 14 BAKER AVE MORPHETTVILLE		D7	CUSTOM	Custom	2116x900			DETAILER	DETAILED
								Jarrood	16-07-2019
								WEIGHT	SCALE
								27	1:25

DESCRIPTION	Usage	No.	Length	Mat.	Qty
Multigrip	TIEDOWN	N/A		3	1
C9075ra	STUD	N/A	2741	0.75	3
U904475G550	TOPPLATE	N/A	898	0.75	2
U904475G550	NOGGING	N/A	888	0.75	1
SCREW-12-14x20-HEX	SCREW	N/A	-	-	4
SCREW-M6-1PX18-TEK	SCREW	N/A	-	-	2
WALLTITE	SCREW	N/A	-	-	18

Length crib: 2
Floor RL: 0
INTERNAL wall

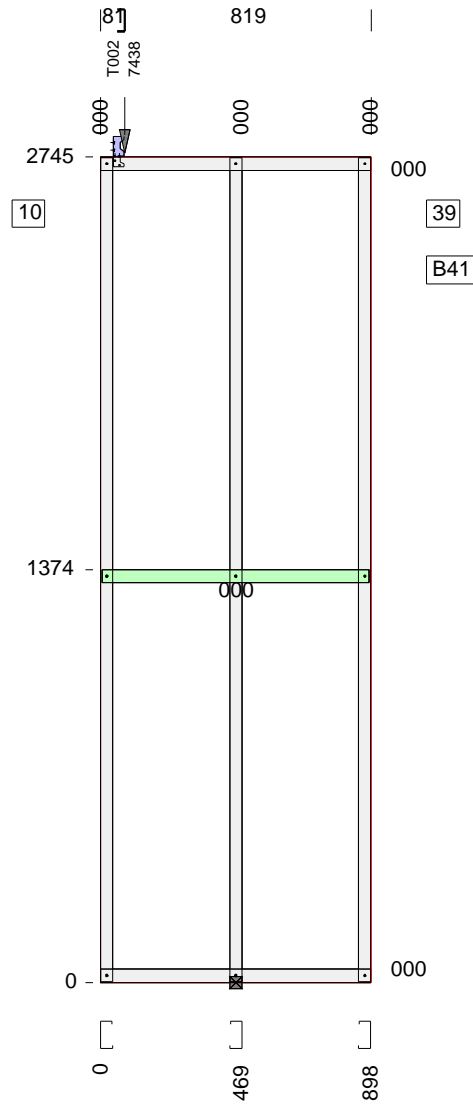

All dimensions to back of section. Where multiple lintels are used in place of a continuous lintel, it should have a minimum lap length of 450mm. Lintels should not be lapped over an opening.

ASSEMBLY DETAILS	OPENING DIMENSIONS (steel to steel)					PACKING DETAILS		LENGTH	MAX. HEIGHT
	ID	HEIGHT	WIDTH	HEAD	SILL	LEFT SIDE	RIGHT SIDE	898	2745
ASSEMBLED: FABRICATOR: TRUE STEEL FRAMES CUSTOMER: BERT FARINA CONSTRUCTIONS CLIENT REF: DW2 14 BAKER AVE MORPHETTVILLE								DETAILER	DETAILED
								Jarrood	16-07-2019
								WEIGHT	SCALE
								12	1:25

DESCRIPTION	Usage	No.	Length	Mat.	Qty
Washer40x40x5	HOLDDOWN	N/A		5	2
Multigrip	TIEDOWN	N/A		3	5
C9075ra	STUD	N/A	2741	0.75	8
C9075ra	STUD	N/A	2637	0.75	2
C9075ra	STUD	N/A	512	0.75	3
C9075ra	STUD	N/A	1299	0.75	3
U904475G550	BOTPLATE	N/A	4918	0.75	2
U904475G550	HEAD	N/A	2022	0.75	3
C10015	HEADER	N/A	1948	1.5	1
U904475G550	NOGGING	N/A	1164	0.75	1
U904475G550	NOGGING	N/A	1874	0.75	1
SCREW-12-14x20-HEX	SCREW	N/A	-	-	20
SCREW-M6-1PX18-TEK	SCREW	N/A	-	-	10
WALLTITE	SCREW	N/A	-	-	104

Length crib: 2
Floor RL: 0
EXTERNAL wall

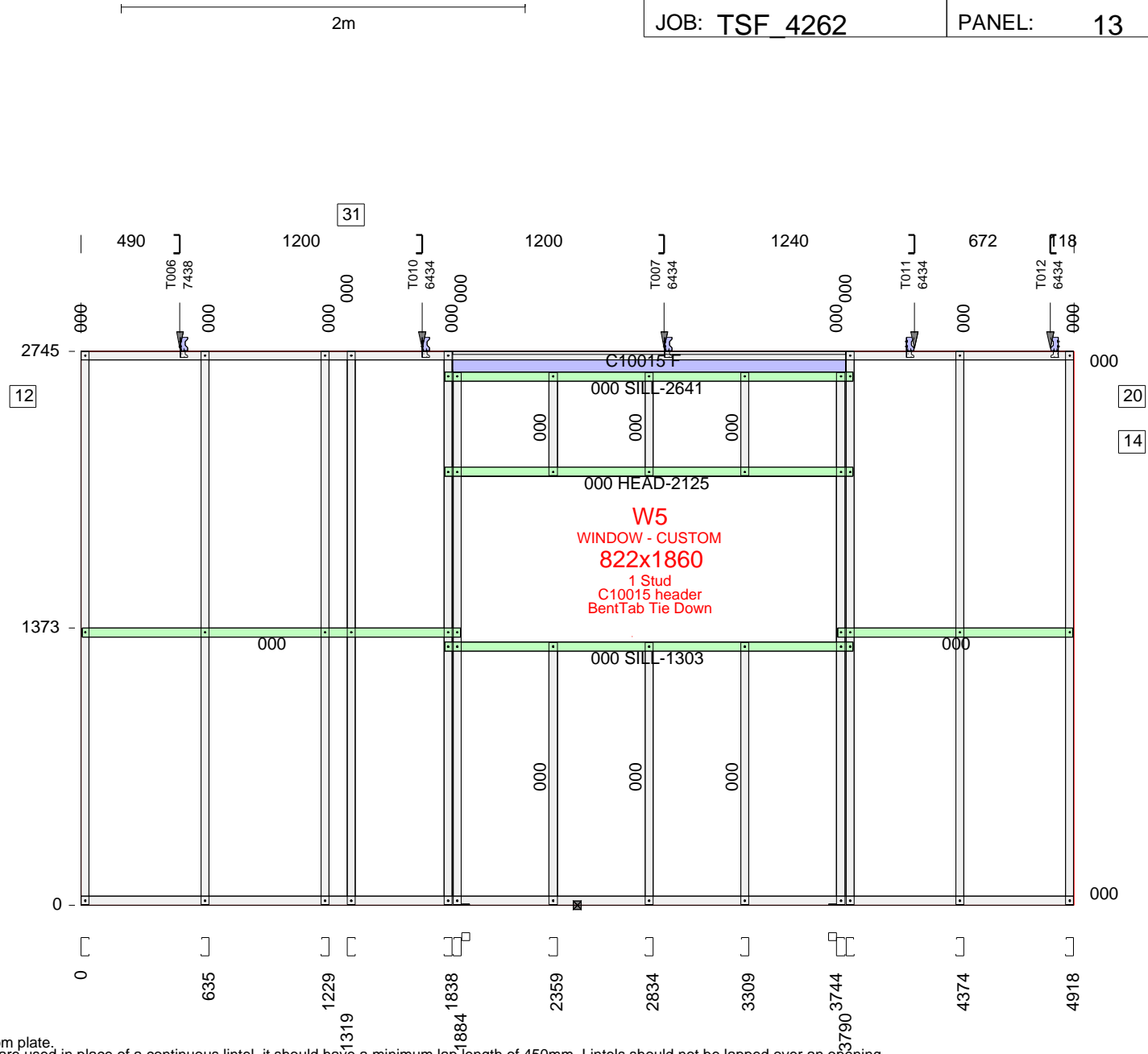

Add membrane to underside and external flange of bottom plate.
All dimensions to back of section. Where multiple lintels are used in place of a continuous lintel, it should have a minimum lap length of 450mm. Lintels should not be lapped over an opening.

ASSEMBLY DETAILS	OPENING DIMENSIONS (steel to steel)				PACKING DETAILS		LENGTH	MAX. HEIGHT
	ID	MANUF.	CAT NO.	UNIT DIM.	LEFT SIDE	RIGHT SIDE	4918	2745
ASSEMBLED:	W5	CUSTOM	Custom	772x1810			DETAILER	DETAILED
FABRICATOR: TRUE STEEL FRAMES							Jarrood	16-07-2019
CUSTOMER: BERT FARINA CONSTRUCTIONS							WEIGHT	SCALE
CLIENT REF: DW2 14 BAKER AVE MORPHETTVILLE							61	1:30

DESCRIPTION	Usage	No.	Length	Mat.	Qty
Washer40x40x5	HOLDDOWN	N/A		5	2
Multigrip	TIEDOWN	N/A		3	3
C9075ra	STUD	N/A	2741	0.75	7
C9075ra	STUD	N/A	2637	0.75	2
C9075ra	STUD	N/A	512	0.75	3
C9075ra	STUD	N/A	1299	0.75	3
U904475G550	TOPPLATE	N/A	3778	0.75	2
U904475G550	HEAD	N/A	2022	0.75	3
C10015	HEADER	N/A	1948	1.5	1
U904475G550	NOGGING	N/A	734	0.75	1
U904475G550	NOGGING	N/A	1164	0.75	1
SCREW-12-14x20-HEX	SCREW	N/A	-	-	12
SCREW-M6-1PX18-TEK	SCREW	N/A	-	-	6
WALLTITE	SCREW	N/A	-	-	98

Length crib: 2
Floor RL: 0
EXTERNAL wall

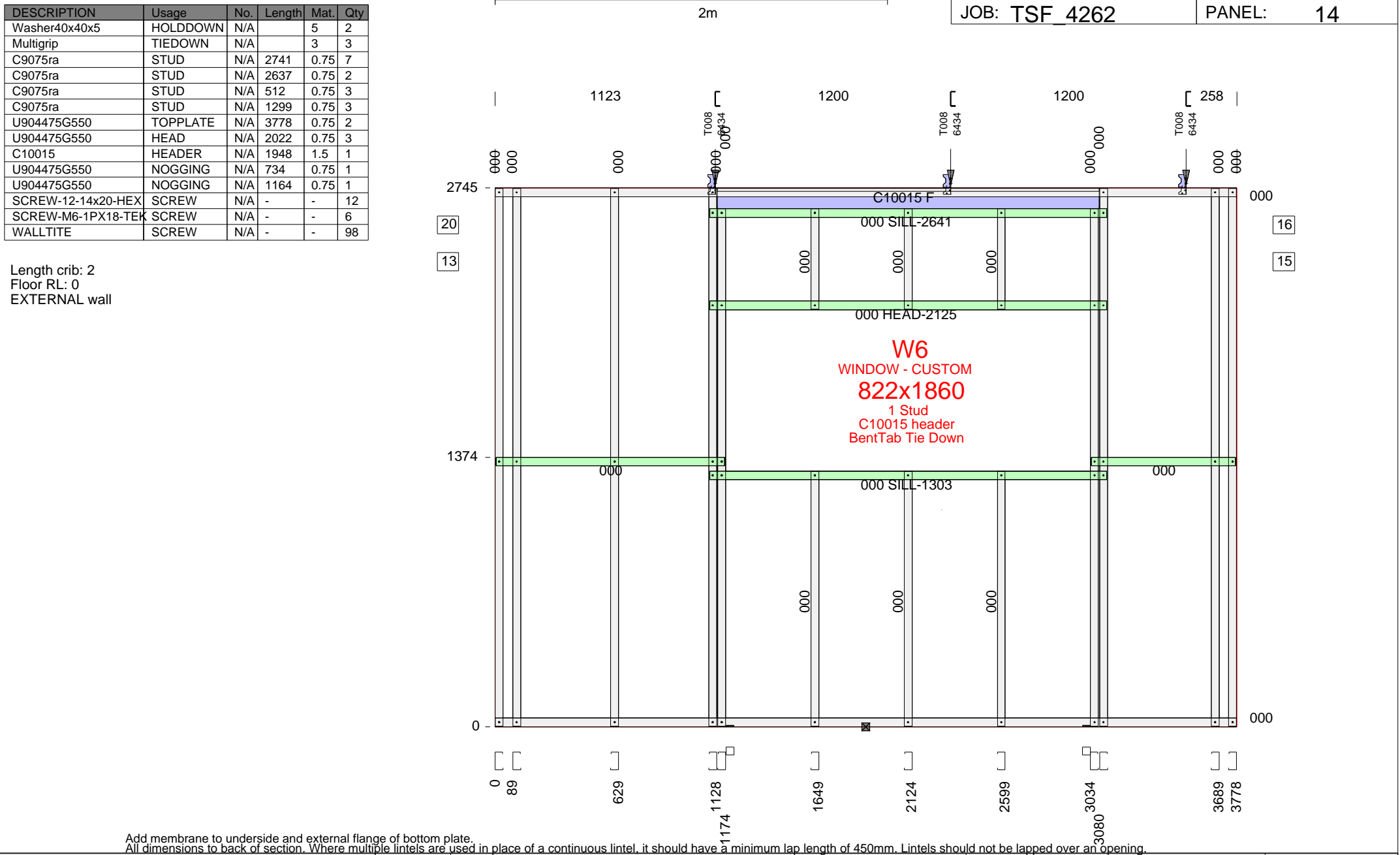

Add membrane to underside and external flange of bottom plate.
All dimensions to back of section. Where multiple lintels are used in place of a continuous lintel, it should have a minimum lap length of 450mm. Lintels should not be lapped over an opening.

ASSEMBLY DETAILS	OPENING DIMENSIONS (steel to steel)				PACKING DETAILS		LENGTH	MAX. HEIGHT
	ID	MANUF.	CAT NO.	UNIT DIM.	LEFT SIDE	RIGHT SIDE	3778	2745
ASSEMBLED:	W6	CUSTOM	Custom	772x1810			DETAILER	DETAILED
FABRICATOR: TRUE STEEL FRAMES							Jarrood	16-07-2019
CUSTOMER: BERT FARINA CONSTRUCTIONS							WEIGHT	SCALE
CLIENT REF: DW2 14 BAKER AVE MORPHETTVILLE							54	1:25

DESCRIPTION	Usage	No.	Length	Mat.	Qty
MULTIGRIP	TIEDOWN	N/A		3	5
Washer40x40x5	HOLDDOWN	N/A		5	4
C9075ra	STUD	N/A	2741	0.75	12
C9075ra	STUD	N/A	2591	0.75	2
U904475G550	TOPPLATE	N/A	6629	0.75	1
U904475G550	BOTPLATE	N/A	6778	0.75	1
U904475G550	SILL	N/A	179	0.75	1
U904475G550	NOGGING	N/A	6768	0.75	1
C9075ra	STIFFENER	N/A	556	0.75	4
C9075ra	STIFFENER	N/A	551	0.75	1
BRA-1.0x25-250	Brace	N/A	3279	1.0	4
TENSIONER_SET	Tensnr	N/A	0	N/A	4
SCREW-12-14x20-HEX	SCREW	N/A	-	-	20
SCREW-M6-1PX18-TEK	SCREW	N/A	-	-	34
WALLTITE	SCREW	N/A	-	-	116

Length crib: 2
Floor RL: 0
EXTERNAL wall

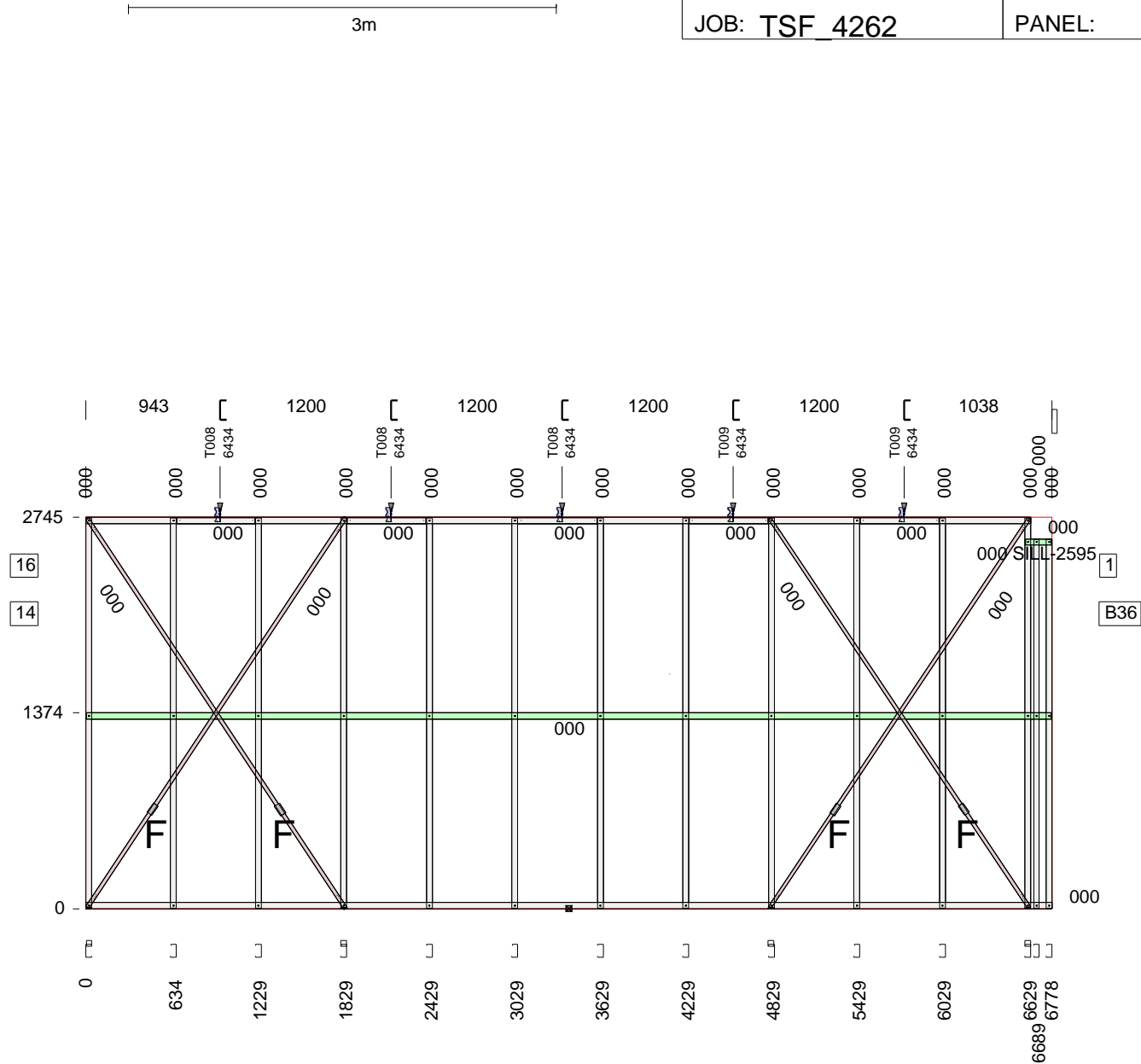

Screws at each end of BRA-1.0x25-250 = 3

Add membrane to underside and external flange of bottom plate.
All dimensions to back of section. Where multiple lintels are used in place of a continuous lintel, it should have a minimum lap length of 450mm. Lintels should not be lapped over an opening.

ASSEMBLY DETAILS	OPENING DIMENSIONS (steel to steel)					PACKING DETAILS		LENGTH	MAX. HEIGHT
	ID	HEIGHT	WIDTH	HEAD	SILL	LEFT SIDE	RIGHT SIDE	6778	2745
ASSEMBLED: FABRICATOR: TRUE STEEL FRAMES CUSTOMER: BERT FARINA CONSTRUCTIONS CLIENT REF: DW2 14 BAKER AVE MORPHETTVILLE								DETAILER	DETAILED
								Jarrood	16-07-2019
								WEIGHT	SCALE
								69	1:45

DESCRIPTION	Usage	No.	Length	Mat.	Qty
Washer40x40x5	HOLDDOWN	N/A		5	4
C9055ra	STUD	N/A	2706	0.55	3
U904475G550	TOPPLATE	N/A	3112	0.75	2
U904475G550	NOGGING	N/A	3102	0.75	1
BRA-1.0x25-250	Brace	N/A	3610	1.0	2
TENSIONER_SET	Tensnr	N/A	0	N/A	4
BRA-1.0x25-250	Brace	N/A	3676	1.0	2
C9075ra	STUD	N/A	2706	0.75	4
SCREW-M6-1PX18-TEK	SCREW	N/A	-	-	24
WALLTITE	SCREW	N/A	-	-	42

Length crib: 2
Floor RL: 0
INTERNAL wall

Screws at each end of BRA-1.0x25-250 = 3

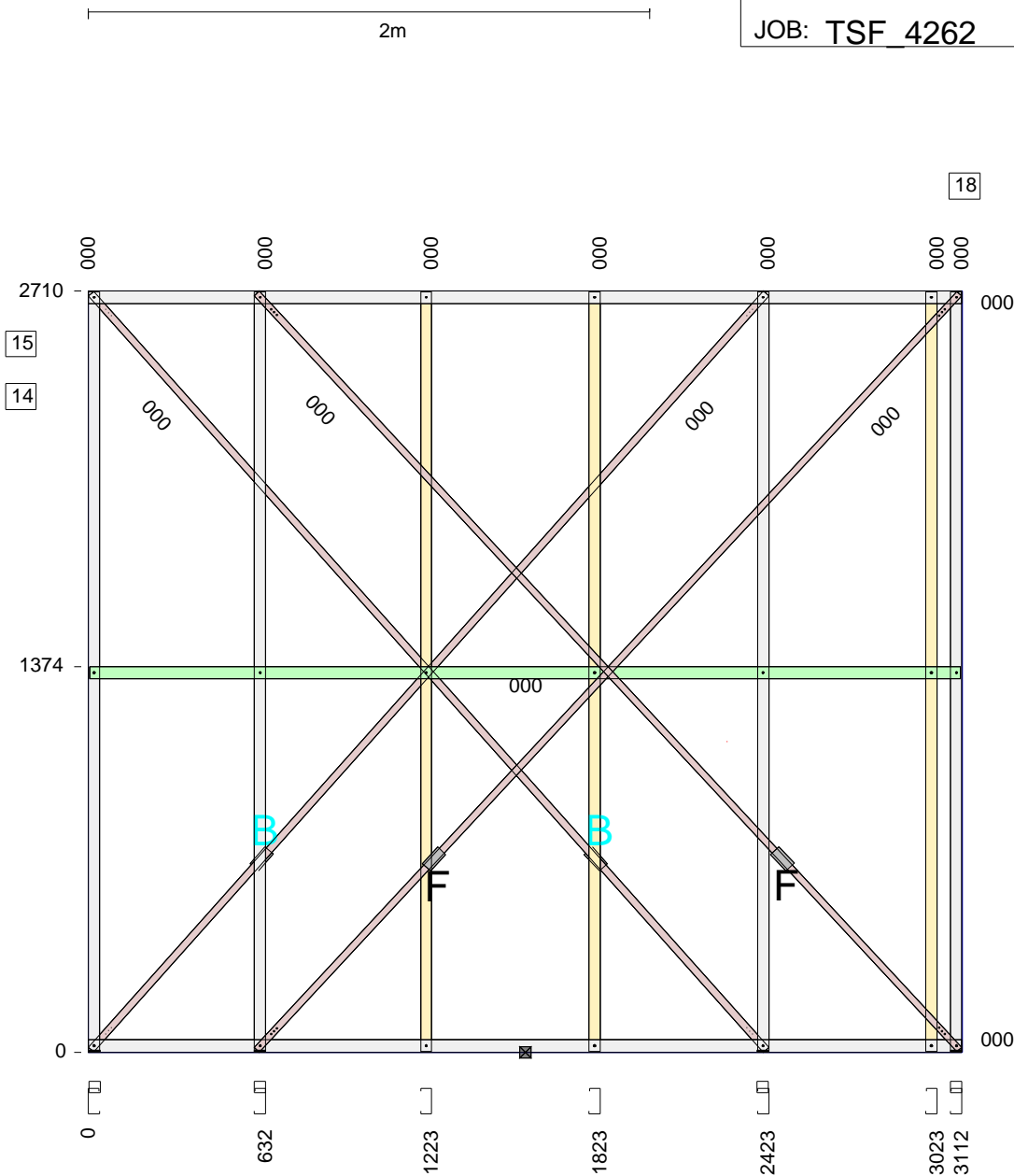

All dimensions to back of section. Where multiple lintels are used in place of a continuous lintel, it should have a minimum lap length of 450mm. Lintels should not be lapped over an opening.

ASSEMBLY DETAILS	OPENING DIMENSIONS (steel to steel)					PACKING DETAILS		LENGTH	MAX. HEIGHT
	ID	HEIGHT	WIDTH	HEAD	SILL	LEFT SIDE	RIGHT SIDE	3112	2710
ASSEMBLED: FABRICATOR: TRUE STEEL FRAMES CUSTOMER: BERT FARINA CONSTRUCTIONS CLIENT REF: DW2 14 BAKER AVE MORPHETTVILLE								DETAILER	DETAILED
								Jarrood	16-07-2019
								WEIGHT	SCALE
								31	1:25

DESCRIPTION	Usage	No.	Length	Mat.	Qty
Washer40x40x5	HOLDDOWN	N/A		5	2
C9075ra	STUD	N/A	2706	0.75	3
C9055ra	STUD	N/A	2706	0.55	4
U904475G550	TOPPLATE	N/A	3138	0.75	2
U904475G550	HEAD	N/A	1079	0.75	1
U904475G550	NOGGING	N/A	2079	0.75	1
C9075ra	STUD	N/A	576	0.75	1
BRA-1.0x25-250	Brace	N/A	3397	1.0	2
TENSIONER_SET	Tensnr	N/A	0	N/A	2
SCREW-M6-1PX18-TEK	SCREW	N/A	-	-	12
WALLTITE	SCREW	N/A	-	-	48

Length crib: 2
Floor RL: 0
INTERNAL wall

Screws at each end of BRA-1.0x25-250 = 3

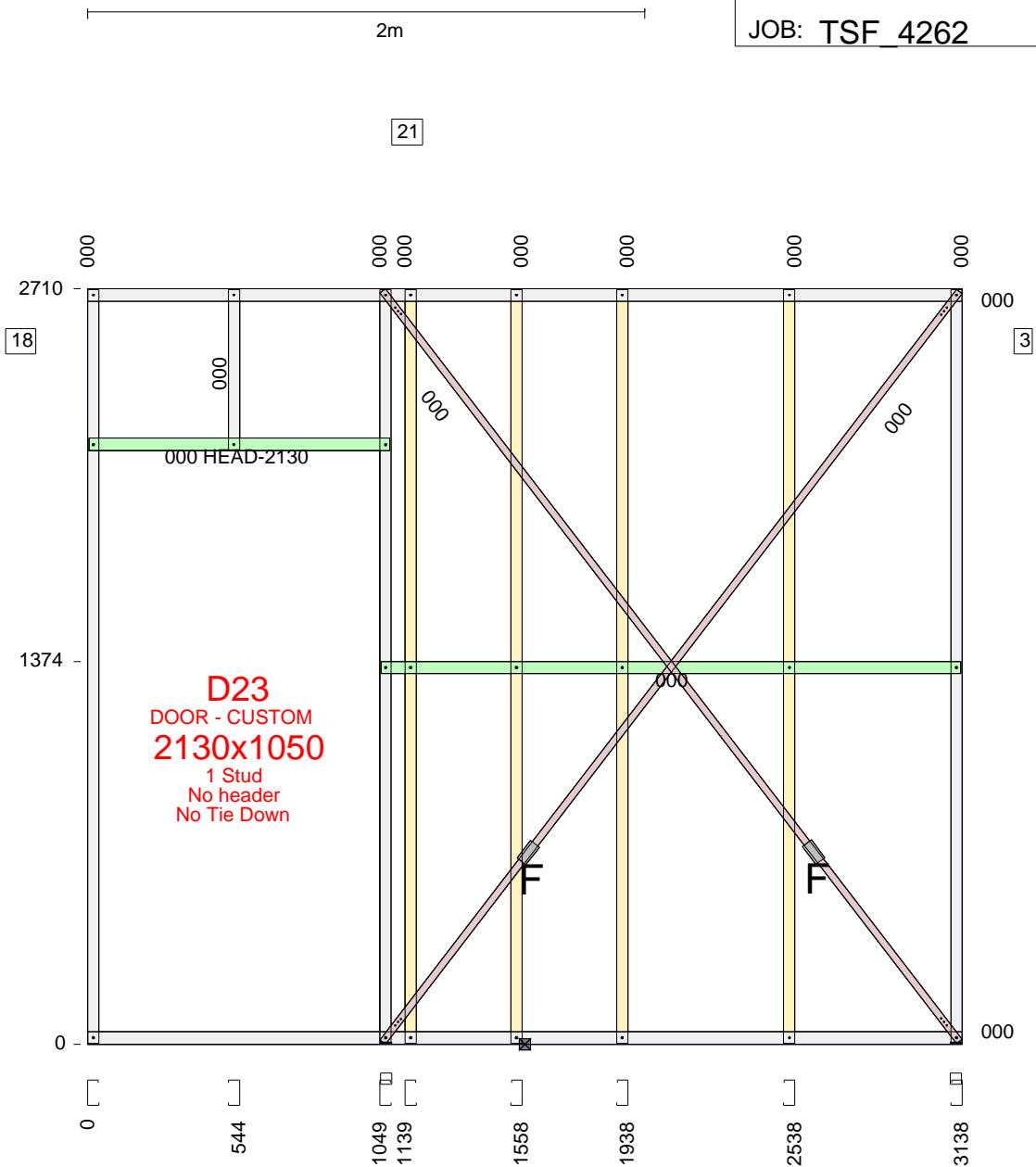

All dimensions to back of section. Where multiple lintels are used in place of a continuous lintel, it should have a minimum lap length of 450mm. Lintels should not be lapped over an opening.

ASSEMBLY DETAILS	OPENING DIMENSIONS (steel to steel)				PACKING DETAILS		LENGTH	MAX. HEIGHT
	ID	MANUF.	CAT NO.	UNIT DIM.	LEFT SIDE	RIGHT SIDE	3138	2710
ASSEMBLED:	D23	CUSTOM	Custom	2130x1050			DETAILER	DETAILED
FABRICATOR: TRUE STEEL FRAMES							Jarrood	16-07-2019
CUSTOMER: BERT FARINA CONSTRUCTIONS							WEIGHT	SCALE
CLIENT REF: DW2 14 BAKER AVE MORPHETTVILLE							30	1:25

DESCRIPTION	Usage	No.	Length	Mat.	Qty
C9055ra	STUD	N/A	2706	0.55	6
C9075ra	STUD	N/A	2706	0.75	2
U904475G550	TOPPLATE	N/A	3598	0.75	2
U904475G550	HEAD	N/A	980	0.75	1
U904475G550	NOGGING	N/A	1979	0.75	1
U904475G550	NOGGING	N/A	689	0.75	1
C9075ra	STUD	N/A	596	0.75	1
WALLTITE	SCREW	N/A	-	-	56

Length crib: 2
Floor RL: 0
INTERNAL wall

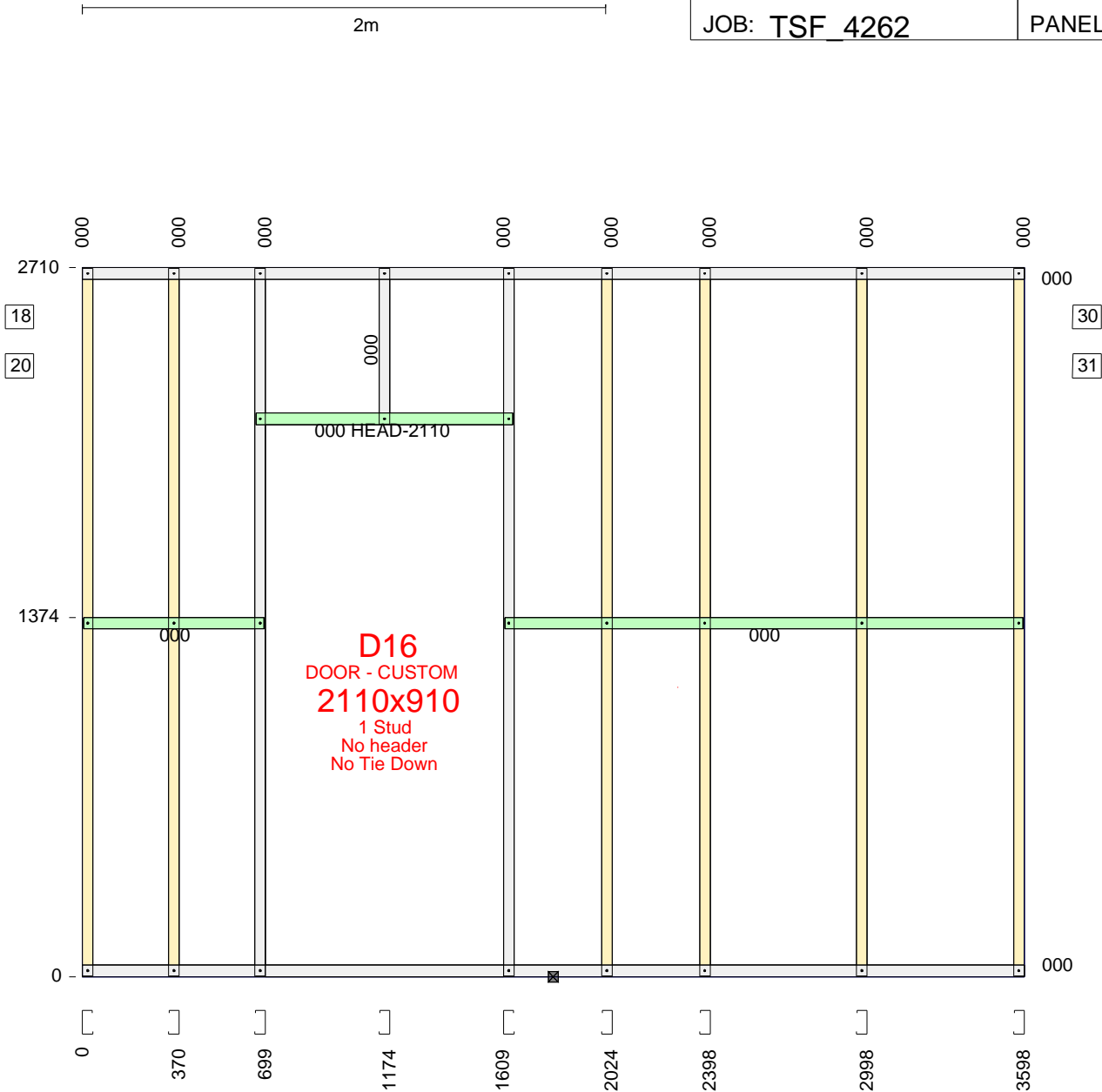

All dimensions to back of section. Where multiple lintels are used in place of a continuous lintel, it should have a minimum lap length of 450mm. Lintels should not be lapped over an opening.

ASSEMBLY DETAILS	OPENING DIMENSIONS (steel to steel)				PACKING DETAILS		LENGTH	MAX. HEIGHT
	ID	MANUF.	CAT NO.	UNIT DIM.	LEFT SIDE	RIGHT SIDE	3598	2710
ASSEMBLED:	D16	CUSTOM	Custom	2040x820			DETAILER	DETAILED
FABRICATOR: TRUE STEEL FRAMES							Jarrood	16-07-2019
CUSTOMER: BERT FARINA CONSTRUCTIONS							WEIGHT	SCALE
CLIENT REF: DW2 14 BAKER AVE MORPHETTVILLE							31	1:25

DESCRIPTION	Usage	No.	Length	Mat.	Qty
Washer40x40x5	HOLDDOWN	N/A		5	4
C9055ra	STUD	N/A	2706	0.55	3
U904475G550	TOPPLATE	N/A	3112	0.75	2
U904475G550	NOGGING	N/A	3102	0.75	1
BRA-1.0x25-250	Brace	N/A	3676	1.0	2
TENSIONER_SET	Tensnr	N/A	0	N/A	4
BRA-1.0x25-250	Brace	N/A	4035	1.0	2
C9075ra	STUD	N/A	2706	0.75	4
SCREW-M6-1PX18-TEK	SCREW	N/A	-	-	24
WALLTITE	SCREW	N/A	-	-	42

Length crib: 2
Floor RL: 0
INTERNAL wall

Screws at each end of BRA-1.0x25-250 = 3

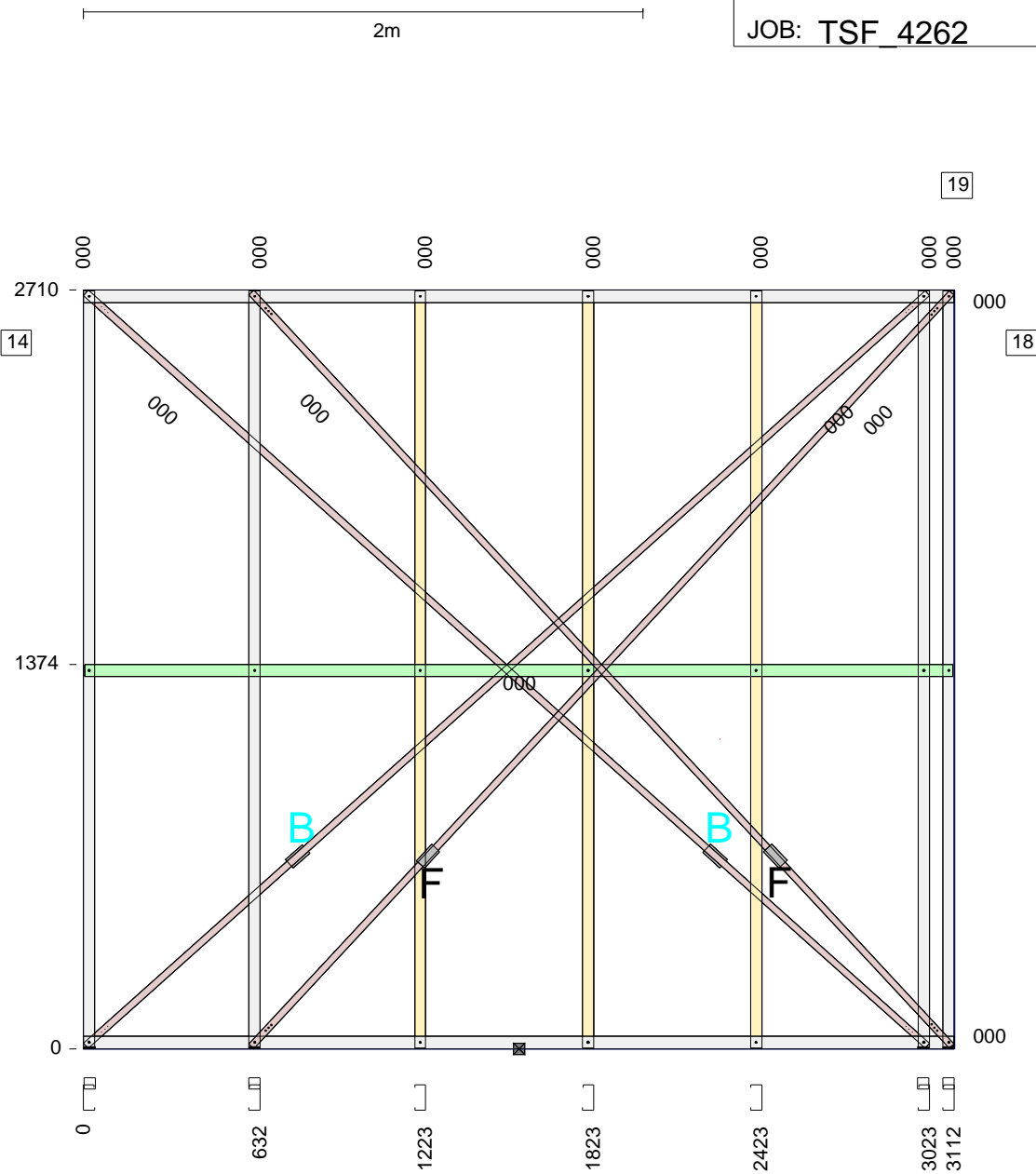

All dimensions to back of section. Where multiple lintels are used in place of a continuous lintel, it should have a minimum lap length of 450mm. Lintels should not be lapped over an opening.

ASSEMBLY DETAILS	OPENING DIMENSIONS (steel to steel)					PACKING DETAILS		LENGTH	MAX. HEIGHT
	ID	HEIGHT	WIDTH	HEAD	SILL	LEFT SIDE	RIGHT SIDE	3112	2710
ASSEMBLED: FABRICATOR: TRUE STEEL FRAMES CUSTOMER: BERT FARINA CONSTRUCTIONS CLIENT REF: DW2 14 BAKER AVE MORPHETTVILLE								DETAILER	DETAILED
								Jarrood	16-07-2019
								WEIGHT	SCALE
								32	1:25

DESCRIPTION	Usage	No.	Length	Mat.	Qty
C9055ra	STUD	N/A	2706	0.55	6
U904475G550	TOPPLATE	N/A	1998	0.75	2
U904475G550	NOGGING	N/A	1988	0.75	1
WALLTITE	SCREW	N/A	-	-	36

Length crib: 2
Floor RL: 0
INTERNAL wall

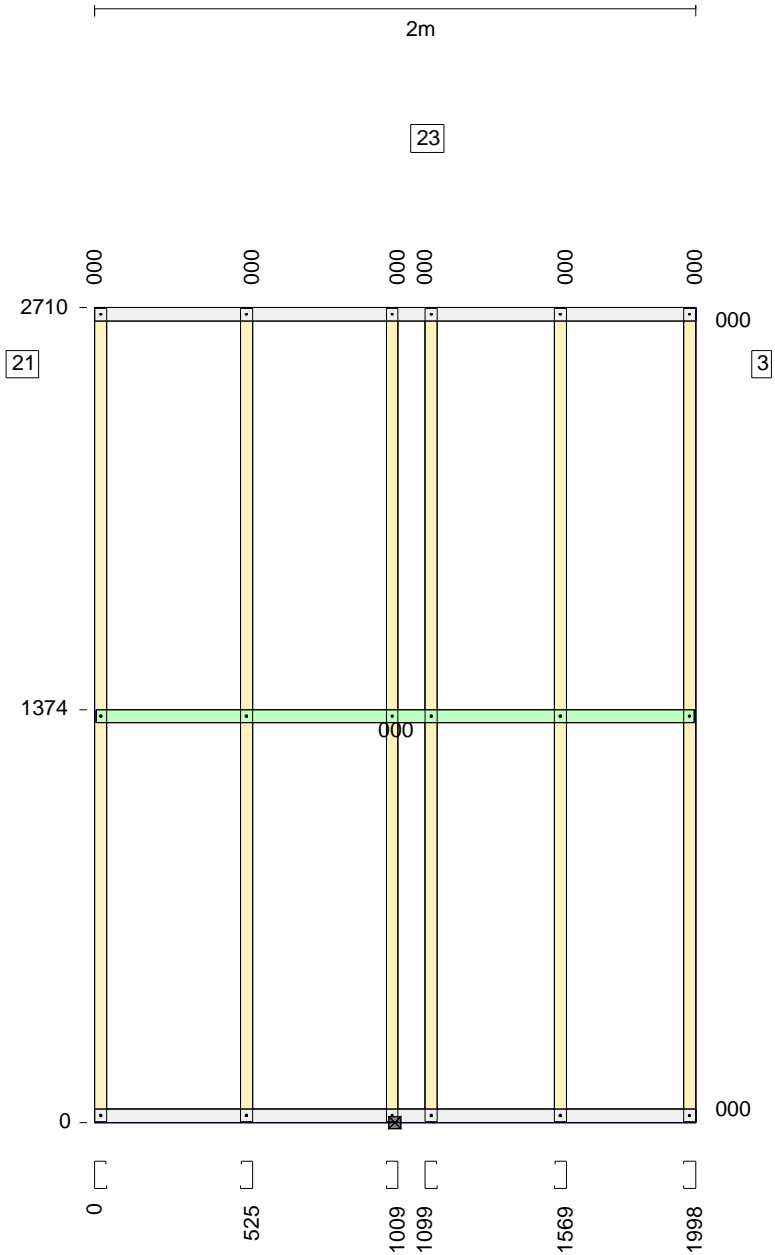

All dimensions to back of section. Where multiple lintels are used in place of a continuous lintel, it should have a minimum lap length of 450mm. Lintels should not be lapped over an opening.

ASSEMBLY DETAILS	OPENING DIMENSIONS (steel to steel)					PACKING DETAILS		LENGTH	MAX. HEIGHT
	ID	HEIGHT	WIDTH	HEAD	SILL	LEFT SIDE	RIGHT SIDE	1998	2710
ASSEMBLED: FABRICATOR: TRUE STEEL FRAMES CUSTOMER: BERT FARINA CONSTRUCTIONS CLIENT REF: DW2 14 BAKER AVE MORPHETTVILLE								DETAILER	DETAILED
								Jarrood	16-07-2019
								WEIGHT	SCALE
								19	1:25

DESCRIPTION	Usage	No.	Length	Mat.	Qty
C9055ra	STUD	N/A	2706	0.55	2
C9075ra	STUD	N/A	2706	0.75	2
U904475G550	TOPPLATE	N/A	1658	0.75	2
U904475G550	HEAD	N/A	939	0.75	1
U904475G550	NOGGING	N/A	739	0.75	1
C9075ra	STUD	N/A	596	0.75	1
WALLTITE	SCREW	N/A	-	-	30

Length crib: 2
Floor RL: 0
INTERNAL wall

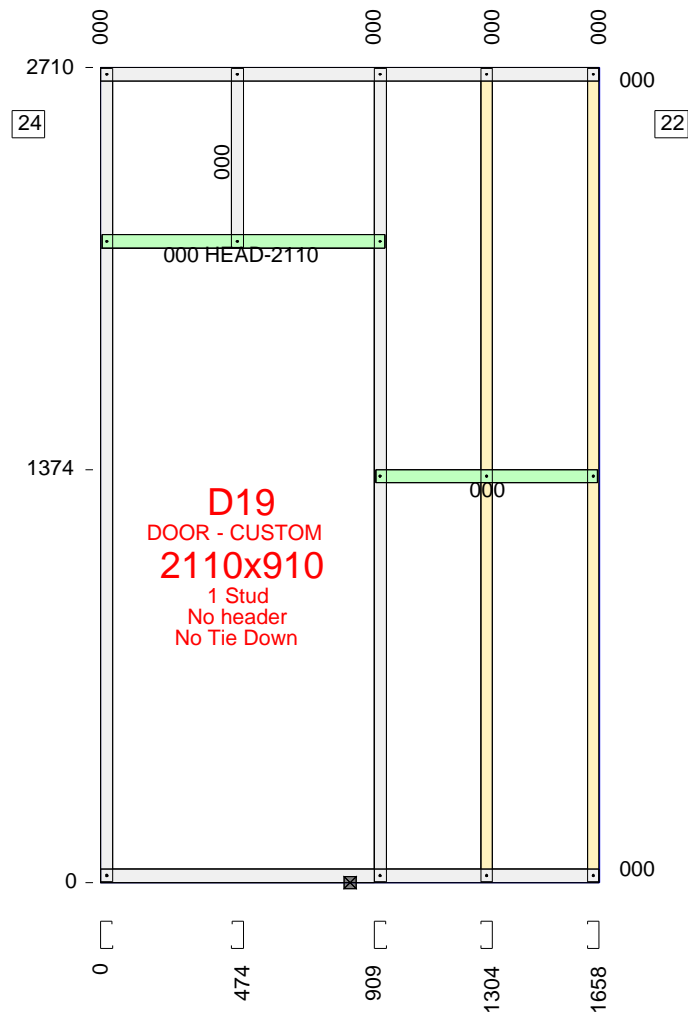

All dimensions to back of section. Where multiple lintels are used in place of a continuous lintel, it should have a minimum lap length of 450mm. Lintels should not be lapped over an opening.

ASSEMBLY DETAILS	OPENING DIMENSIONS (steel to steel)				PACKING DETAILS		LENGTH	MAX. HEIGHT
	ID	MANUF.	CAT NO.	UNIT DIM.	LEFT SIDE	RIGHT SIDE	1658	2710
ASSEMBLED: FABRICATOR: TRUE STEEL FRAMES CUSTOMER: BERT FARINA CONSTRUCTIONS CLIENT REF: DW2 14 BAKER AVE MORPHETTVILLE	D19	CUSTOM	Custom	2040x820			DETAILER	DETAILED
							Jarrood	16-07-2019
							WEIGHT	SCALE
							16	1:25

DESCRIPTION	Usage	No.	Length	Mat.	Qty
Washer40x40x5	HOLDDOWN	N/A		5	2
C9055ra	STUD	N/A	2706	0.55	4
C9075ra	STUD	N/A	2706	0.75	3
U904475G550	TOPPLATE	N/A	2088	0.75	2
U904475G550	HEAD	N/A	980	0.75	1
C9075ra	STUD	N/A	596	0.75	2
U904475G550	NOGGING	N/A	1081	0.75	1
U904475G550	NOGGING	N/A	77	0.75	1
BRA-1.0x25-250	Brace	N/A	2901	1.0	2
TENSIONER_SET	Tensnr	N/A	0	N/A	2
SCREW-M6-1PX18-TEK	SCREW	N/A	-	-	12
WALLTITE	SCREW	N/A	-	-	54

Length crib: 2
Floor RL: 0
INTERNAL wall

Screws at each end of BRA-1.0x25-250 = 3

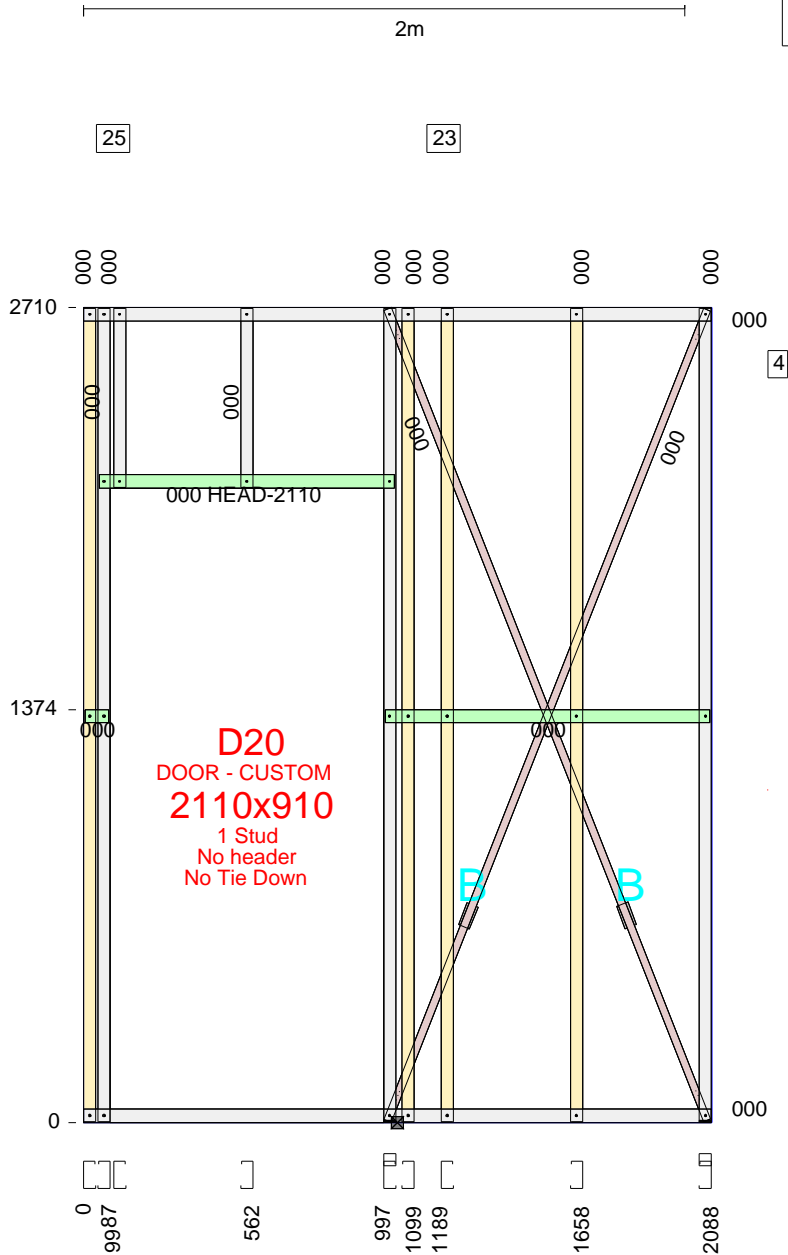

All dimensions to back of section. Where multiple lintels are used in place of a continuous lintel, it should have a minimum lap length of 450mm. Lintels should not be lapped over an opening.

ASSEMBLY DETAILS	OPENING DIMENSIONS (steel to steel)				PACKING DETAILS		LENGTH	MAX. HEIGHT
	ID	MANUF.	CAT NO.	UNIT DIM.	LEFT SIDE	RIGHT SIDE	2088	2710
ASSEMBLED:	D20	CUSTOM	Custom	2040x820			DETAILER	DETAILED
FABRICATOR: TRUE STEEL FRAMES							Jarrood	16-07-2019
CUSTOMER: BERT FARINA CONSTRUCTIONS							WEIGHT	SCALE
CLIENT REF: DW2 14 BAKER AVE MORPHETTVILLE							27	1:25

DESCRIPTION	Usage	No.	Length	Mat.	Qty
Washer40x40x5	HOLDDOWN	N/A		5	2
C9075ra	STUD	N/A	2741	0.75	5
U904475G550	TOPPLATE	N/A	1998	0.75	2
U904475G550	NOGGING	N/A	1988	0.75	1
BRA-1.0x25-250	Brace	N/A	3369	1.0	2
TENSIONER_SET	Tensnr	N/A	0	N/A	2
SCREW-M6-1PX18-TEK	SCREW	N/A	-	-	12
WALLTITE	SCREW	N/A	-	-	30

Length crib: 2
Floor RL: 0
INTERNAL wall

Screws at each end of BRA-1.0x25-250 = 3

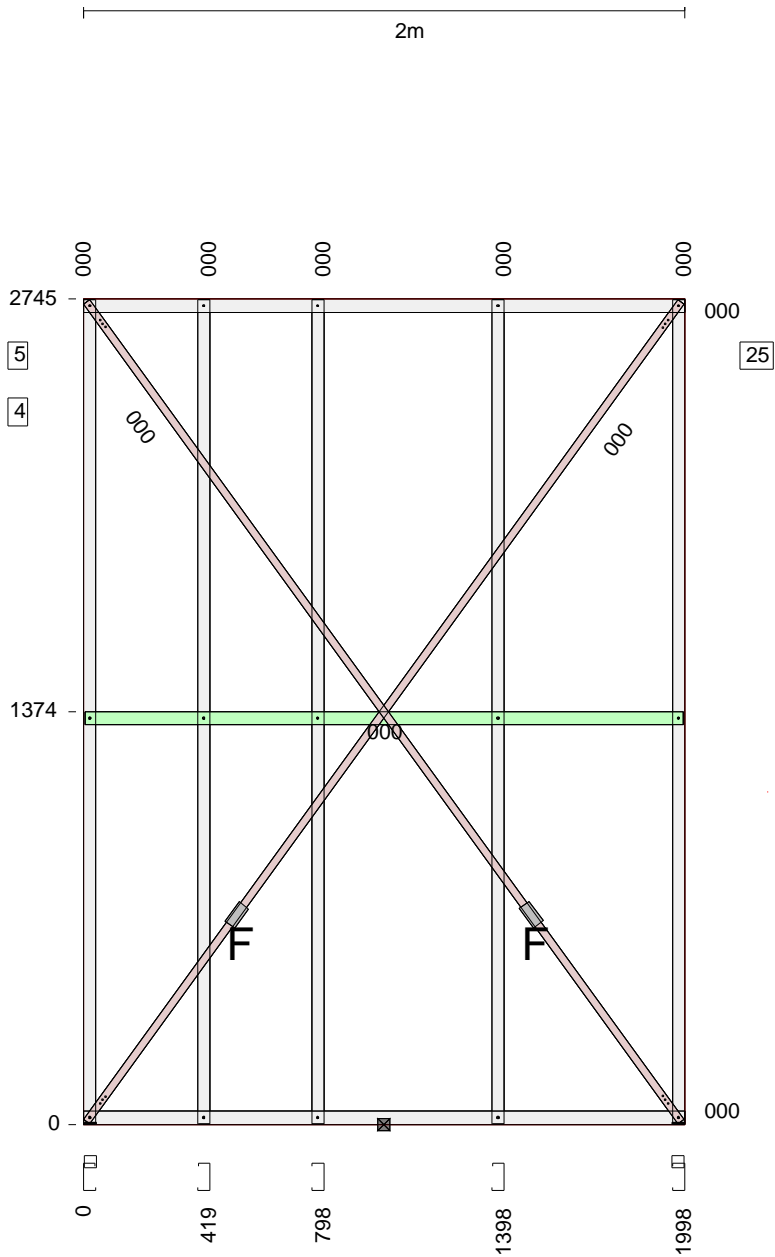

All dimensions to back of section. Where multiple lintels are used in place of a continuous lintel, it should have a minimum lap length of 450mm. Lintels should not be lapped over an opening.

ASSEMBLY DETAILS	OPENING DIMENSIONS (steel to steel)					PACKING DETAILS		LENGTH	MAX. HEIGHT
	ID	HEIGHT	WIDTH	HEAD	SILL	LEFT SIDE	RIGHT SIDE	1998	2745
ASSEMBLED:								DETAILER	DETAILED
FABRICATOR: TRUE STEEL FRAMES								Jarrood	16-07-2019
CUSTOMER: BERT FARINA CONSTRUCTIONS								WEIGHT	SCALE
CLIENT REF: DW2 14 BAKER AVE MORPHETTVILLE								23	1:25

DESCRIPTION	Usage	No.	Length	Mat.	Qty
C9055ra	STUD	N/A	2706	0.55	4
U904475G550	TOPPLATE	N/A	1798	0.75	2
U904475G550	NOGGING	N/A	1788	0.75	1
WALLTITE	SCREW	N/A	-	-	24

Length crib: 2
Floor RL: 0
INTERNAL wall

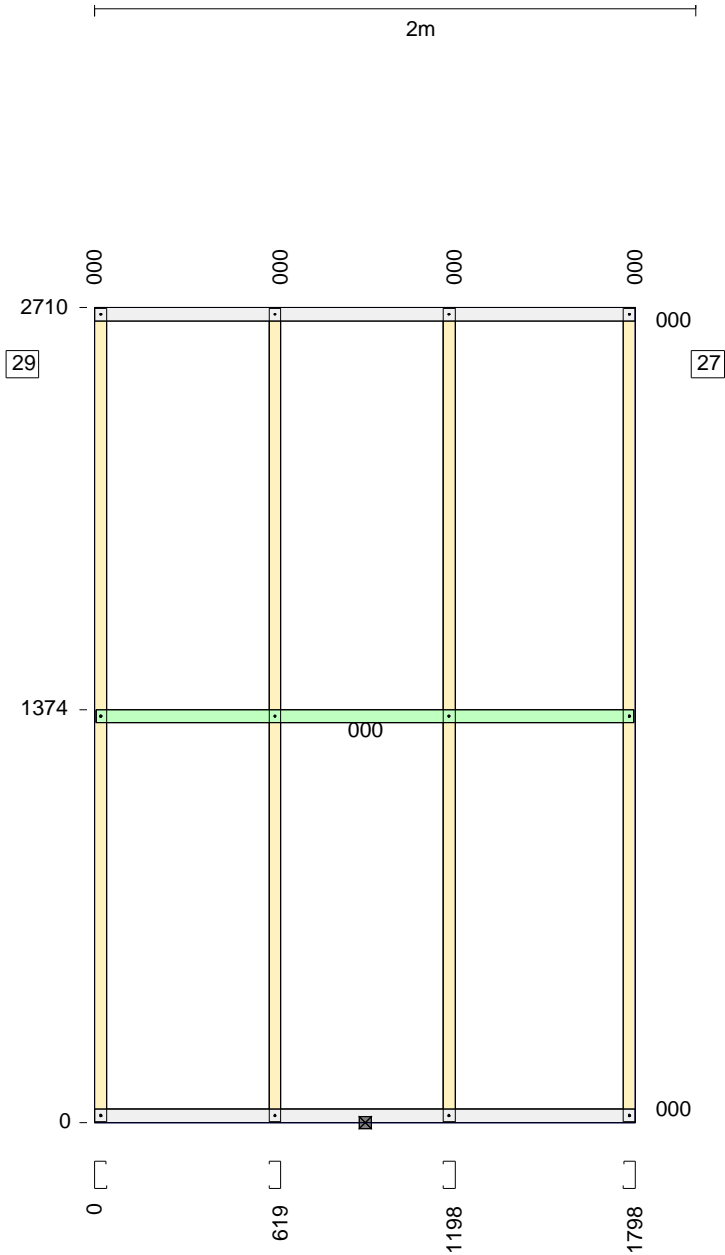

All dimensions to back of section. Where multiple lintels are used in place of a continuous lintel, it should have a minimum lap length of 450mm. Lintels should not be lapped over an opening.

ASSEMBLY DETAILS	OPENING DIMENSIONS (steel to steel)					PACKING DETAILS		LENGTH	MAX. HEIGHT
	ID	HEIGHT	WIDTH	HEAD	SILL	LEFT SIDE	RIGHT SIDE	1798	2710
ASSEMBLED: FABRICATOR: TRUE STEEL FRAMES CUSTOMER: BERT FARINA CONSTRUCTIONS CLIENT REF: DW2 14 BAKER AVE MORPHETTVILLE								DETAILER	DETAILED
								Jarrood	16-07-2019
								WEIGHT	SCALE
								14	1:25

DESCRIPTION	Usage	No.	Length	Mat.	Qty
Washer40x40x5	HOLDDOWN	N/A		5	4
C9075ra	STUD	N/A	2706	0.75	4
C9055ra	STUD	N/A	2706	0.55	4
U904475G550	TOPPLATE	N/A	3002	0.75	2
U904475G550	HEAD	N/A	970	0.75	1
U904475G550	NOGGING	N/A	891	0.75	1
U904475G550	NOGGING	N/A	1191	0.75	1
C9075ra	STUD	N/A	581	0.75	1
BRA-1.0x25-250	Brace	N/A	2837	1.0	2
TENSIONER_SET	Tensnr	N/A	0	N/A	4
BRA-1.0x25-250	Brace	N/A	2941	1.0	2
SCREW-M6-1PX18-TEK	SCREW	N/A	-	-	24
WALLTITE	SCREW	N/A	-	-	56

Length crib: 2
Floor RL: 0
INTERNAL wall

Screws at each end of BRA-1.0x25-250 = 3

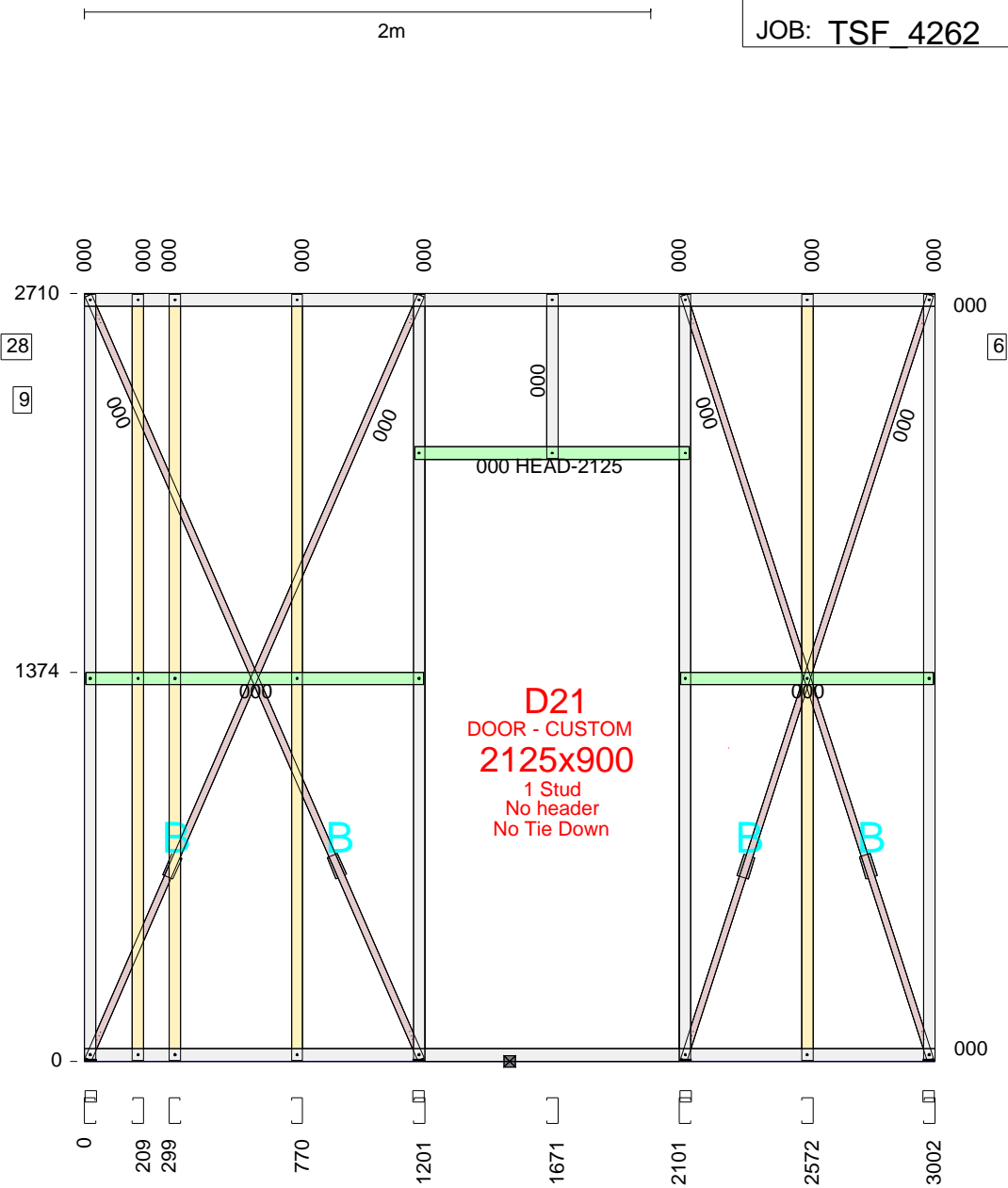

All dimensions to back of section. Where multiple lintels are used in place of a continuous lintel, it should have a minimum lap length of 450mm. Lintels should not be lapped over an opening.

ASSEMBLY DETAILS	OPENING DIMENSIONS (steel to steel)				PACKING DETAILS		LENGTH	MAX. HEIGHT
	ID	MANUF.	CAT NO.	UNIT DIM.	LEFT SIDE	RIGHT SIDE	3002	2710
ASSEMBLED:	D21	CUSTOM	Custom	2125x900			DETAILER	DETAILED
FABRICATOR: TRUE STEEL FRAMES							Jarrood	16-07-2019
CUSTOMER: BERT FARINA CONSTRUCTIONS							WEIGHT	SCALE
CLIENT REF: DW2 14 BAKER AVE MORPHETTVILLE							33	1:25

DESCRIPTION	Usage	No.	Length	Mat.	Qty
C9055ra	STUD	N/A	2706	0.55	8
C9075ra	STUD	N/A	2706	0.75	2
U904475G550	TOPPLATE	N/A	5268	0.75	2
U904475G550	HEAD	N/A	980	0.75	1
U904475G550	NOGGING	N/A	4159	0.75	1
U904475G550	NOGGING	N/A	179	0.75	1
C9075ra	STUD	N/A	596	0.75	1
WALLTITE	SCREW	N/A	-	-	68

Length crib: 2
Floor RL: 0
INTERNAL wall

JOB: TSF_4262

PANEL: 30

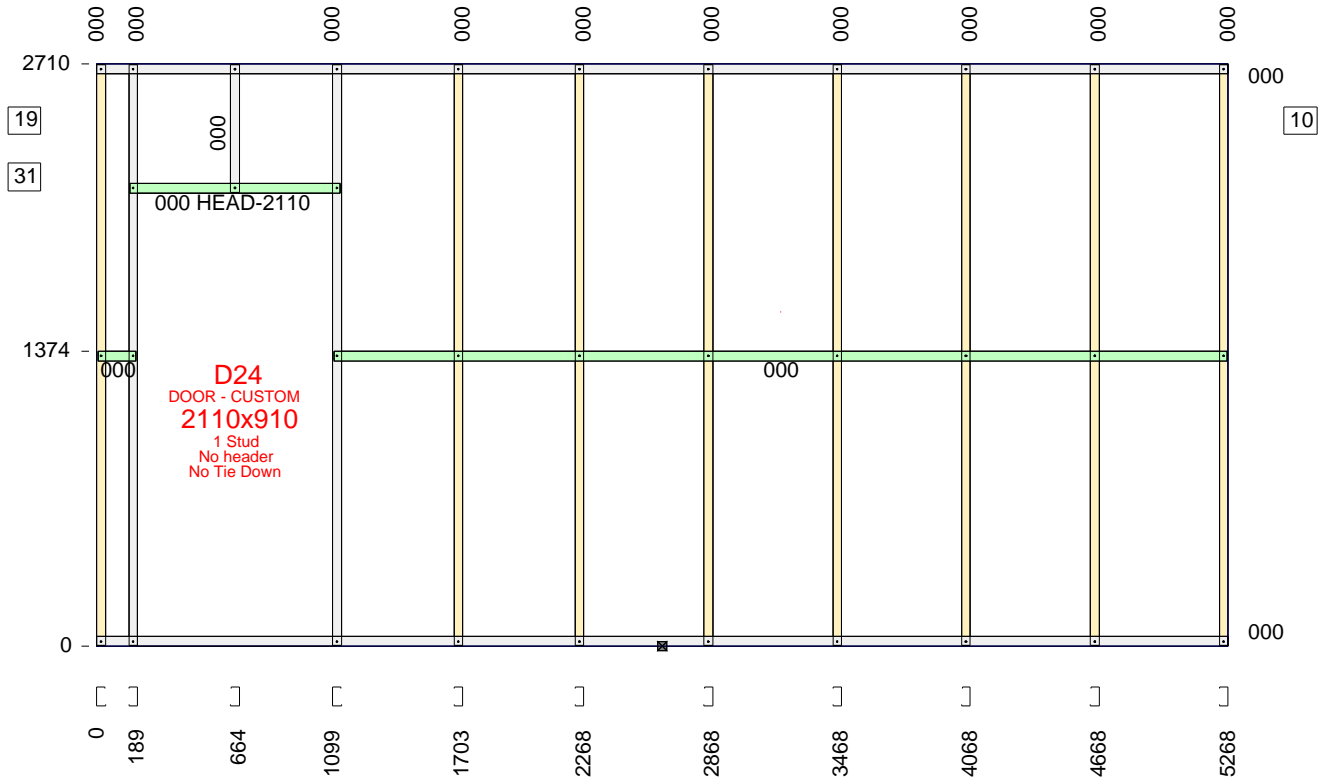

All dimensions to back of section. Where multiple lintels are used in place of a continuous lintel, it should have a minimum lap length of 450mm. Lintels should not be lapped over an opening.

ASSEMBLY DETAILS	OPENING DIMENSIONS (steel to steel)				PACKING DETAILS		LENGTH	MAX. HEIGHT
	ID	MANUF.	CAT NO.	UNIT DIM.	LEFT SIDE	RIGHT SIDE	5268	2710
ASSEMBLED: FABRICATOR: TRUE STEEL FRAMES CUSTOMER: BERT FARINA CONSTRUCTIONS CLIENT REF: DW2 14 BAKER AVE MORPHETTVILLE	D24	CUSTOM	Custom	2040x820			DETAILER	DETAILED
							Jarrood	16-07-2019
							WEIGHT	SCALE
							41	1:35

DESCRIPTION	Usage	No.	Length	Mat.	Qty
Washer40x40x5	HOLDDOWN	N/A		5	2
C9055ra	STUD	N/A	2706	0.55	4
U904475G550	TOPPLATE	N/A	3022	0.75	2
U904475G550	NOGGING	N/A	3012	0.75	1
BRA-1.0x25-250	Brace	N/A	4034	1.0	4
TENSIONER_SET	Tensnr	N/A	0	N/A	4
C9075ra	STUD	N/A	2706	0.75	2
SCREW-M6-1PX18-TEK	SCREW	N/A	-	-	24
WALLTITE	SCREW	N/A	-	-	36

Length crib: 2
Floor RL: 0
INTERNAL wall

Screws at each end of BRA-1.0x25-250 = 3

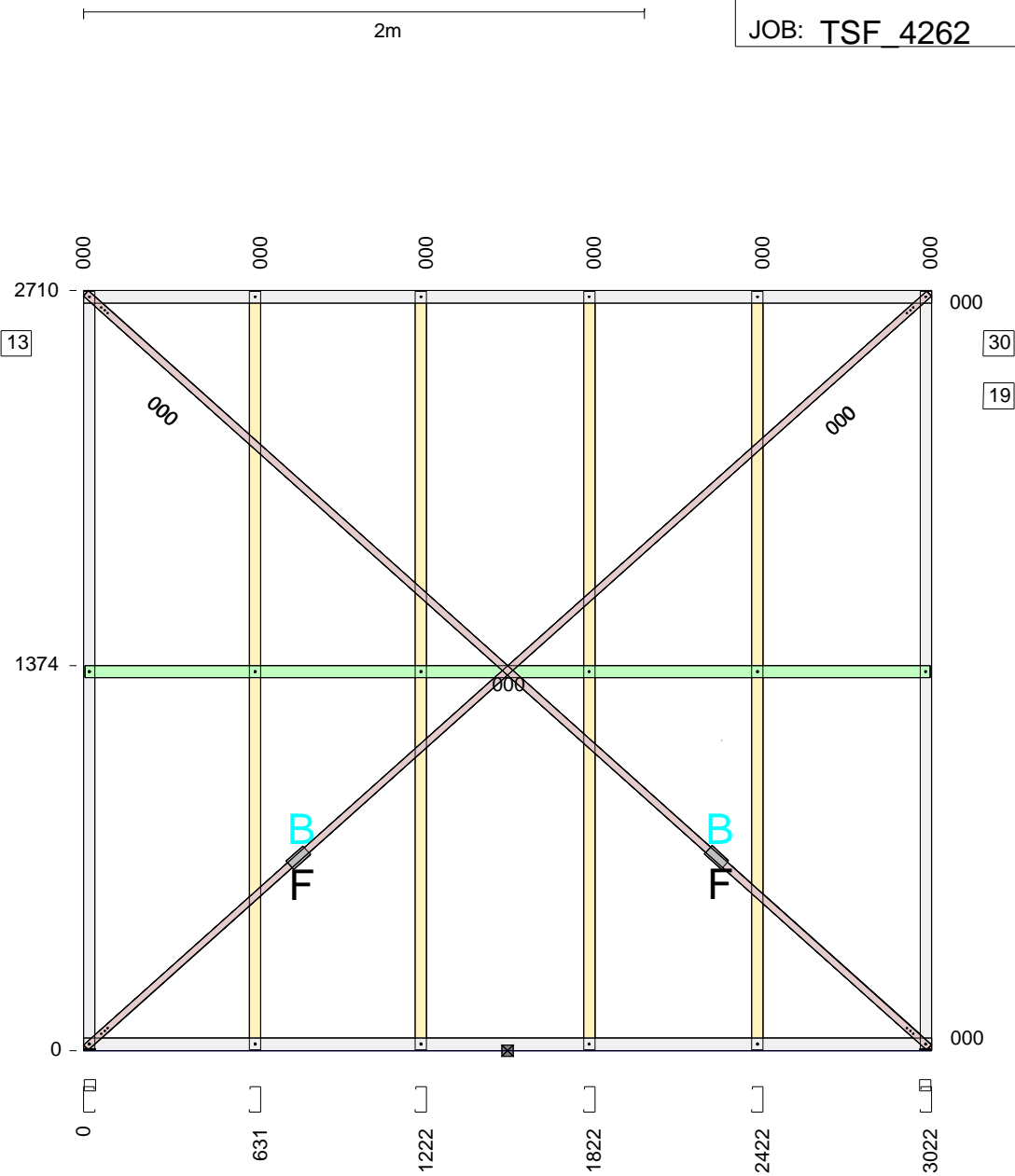

All dimensions to back of section. Where multiple lintels are used in place of a continuous lintel, it should have a minimum lap length of 450mm. Lintels should not be lapped over an opening.

ASSEMBLY DETAILS	OPENING DIMENSIONS (steel to steel)					PACKING DETAILS		LENGTH	MAX. HEIGHT
	ID	HEIGHT	WIDTH	HEAD	SILL	LEFT SIDE	RIGHT SIDE	3022	2710
ASSEMBLED:								DETAILER	DETAILED
FABRICATOR: TRUE STEEL FRAMES								Jarrood	16-07-2019
CUSTOMER: BERT FARINA CONSTRUCTIONS								WEIGHT	SCALE
CLIENT REF: DW2 14 BAKER AVE MORPHETTVILLE								28	1:25